



# Compressed Air Treatment

Catalogue S3.2.111a



# Parker Filtration - Process Air and Gas Division

## Compressed Air Treatment

Superior protection from the damaging and costly effects of oil, water and dirt...

- Filter elements that offer both market leading performance and efficiency and are environmentally friendly in their manufacture and disposal.
- Housings ranging from 1/4" to DN200 coded vessels, together with a full range of drain and differential pressure gauge options.
- A wide range of filtration efficiencies to provide the exact filtration that's required. From bulk water separation through to bacteria removal for sterile air.
- Innovative membrane air dryers that provide clean dry air with dew points down to -40°C, without any moving parts or the requirement for additional power.
- The inherent advantages of Parker filter elements are available in a range of filter elements sized to fit other manufacturers housings, offering the opportunity to upgrade to a Parker filter.

## Gas Filtration

Filtration for sampling systems, analyser applications and process gases providing protection - pure and simple...

- Remove liquids & solids from gases with up to 99.9999+% efficiency at 0.01 µm.
- Specially configured filter media for applications such as carbon dioxide purification, alternative fuels and steam filtration.
- Temperature resistance to 538°C and a maximum pressure of 345 barg.
- Low pressure drop and a long life between filter element changes.

## Process Liquid Filtration

Process liquid filtration providing purification and clarification for the beverage, chemical processing, cosmetic, food processing, metalworking, paint, ink, pharmaceutical and water treatment industries...

- Parker's line of membrane cartridges is ideal for critical applications where high performance is required.
- Parker's pleated depth filter series of cartridges provide high flow long life filtration, including absolute and nominal rated cartridges available in polypropylene, microglassfibre and cellulose.
- Wound Depth, Resin Bonded and Melt Blown filter cartridge series from Parker together with Filter Bag Media, Strainers, Metallic Media and Sorbent Media providing a range of choices to ensure the correct filtration for your application.
- Parker coded and non-coded vessels available for a broad range of applications.

## On-Site Nitrogen Generators

Nitrogen is the most widely used gas in industry since it can prevent the risk of explosion or stop product degradation. Nitrogen is being used in new and exciting applications such as tyre filling for cars, motorcycles and trucks...

- Parker's proprietary hollow fibre membrane technology simply and elegantly separates nitrogen from compressed air.
- Generators such as the NitroSource will provide a supply of nitrogen from house compressed air, whilst units such as the Micro provide a plug-and-play solution with the inclusion of an integrated compressor.

Gas Filtration



Analytical Gas Generators



Nitrogen Generation



Process Liquid Filtration



Compressed Air Treatment



Filtration for Vacuum Pumps



OEM Compressed Air Treatment Solutions



# Contents

---

<b>Understanding Compressed Air Filtration .....</b>	<b>4</b>
--	----------

## **Providing Air, free from Oil, Dirt and Condensate**

Filtration Media Grades .....	6
Filter Silencers .....	7
Miniture Point-of-Use Filters.....	8
Compressed Air Filters 1/4" to 1 1/2" .....	10
Compressed Air Filters 2" to 3" .....	12
Compressed Air Filters DN100 - DN200 .....	13
Stainless Steel Compressed Air Filters .....	14
Breathing Air Purifiers .....	16
Medium and High Pressure Filters .....	17
Flow Rates .....	18

## **Producing Dry (Low Dew Point) Air**

Parker Membrane Technology.....	19
System Membrane Air Dryers .....	20
Point-of-Use Membrane Dryers +2°C Dew Point .....	22
Point-of-Use Membrane Dryers -40°C Dew Point .....	24
Point-of-Use Desiccant Dryers .....	26

<b>Zero Air Loss Drains .....</b>	<b>27</b>
-----------------------------------	-----------

<b>Nitrogen Generators From Parker .....</b>	<b>28</b>
--	-----------

<b>Par-Fit Alternative Elements .....</b>	<b>30</b>
---	-----------

<b>Accessories .....</b>	<b>34</b>
--------------------------	-----------

<b>Global Company Local Support .....</b>	<b>35</b>
---	-----------

# Understanding Compressed Air Filtration

**Compressed air is expensive to produce and must be properly treated in order to limit maintenance costs, downtime and spoilage. Parker compressed air filters remove the water, oil and dirt which form the contaminants of compressed air.**

## Protection where it's needed...

Stopping corrosion from compressed air at 20°C and 7 barg requires an extremely low dew point of -30°C, so even if an application is not particularly sensitive to impurities – for example an air driven tool – it's advisable to have a point-of-use filter. Any rust particles, pipe scale and water condensed out in the line will need to be removed or they will cause problems.

Water, dirt, degraded oil and bacteria can form an abrasive sludge; this will bring with it higher costs through spoilt product, broken tools, increased air line leakage and the resulting additional maintenance required. Parker compressed air filters provide you with the protection you need from these contaminants.

The diagrams (to the right) demonstrate the different configurations of Parker compressed air filters and dryers to provide a variety of the ISO compressed air qualities.

## Green and Lean – Protection that doesn't cost the earth...

Parker compressed air filter elements are manufactured to offer advantages in addition to their great filtration performance. Parker elements have a self-supporting, rigid structure, this means that less of the world's valuable resources are used in their construction when compared with other designs. Also Parker are probably the most cost effective elements on the market, giving a low cost of ownership. The design of Parker elements means that they cost you less to use, since low pressure drop is an inherent feature. This helps to keep down the energy consumption of your compressed air system – an important consideration for users with the climate change levy.

## Why Parker offer such high efficiency with a low pressure drop...

Parker compressed air filters are constructed from a random bed of borosilicate glass fibres, which are held in a rigid structure by a fluorocarbon resin binder.

The diameter of these fibres is approximately one micron, with the void spaces around the fibres being much larger. This high proportion of space ensures a low flow resistance (pressure drop) and long life.

## Collision, not sieving...

Parker provides you with high efficiency filtration through filters designed to use mechanisms that capture contaminants within the filter, whilst intermolecular forces act to hold the contaminants in the filter.

When contaminants collide with a fibre they're captured. Intermolecular attraction is strong enough to prevent unloading of contaminants downstream and will permanently hold particulate.

## 'Coalescing' making big drops from little ones...

A solid particle, once captured, cannot be removed. A liquid droplet, however, runs down the length of the fibre until it reaches a fibre crossover point. When many liquid droplets run together, the liquid collected at the fibre crossover point becomes a larger droplet. The larger droplet is then gradually pushed through the fibre mat by the flow of air or gas, picking up other droplets along the way, until it appears as a very large droplet on the downstream surface of the filter. Thus, the filter removes very fine liquid droplets from the gas stream and converts them into large droplets of liquid, which can be readily drained from the system. This process is called "coalescing".

## Why inside-to-outside flow?

Since the coalesced liquid appears on the downstream surface after having passed completely through the filter, the liquid will drip from this surface. In all Parker coalescing filters, the flow direction through the filter cartridge is inside-to-outside. A Parker filter will coalesce liquid droplets indefinitely without loss of efficiency or flow capacity, because the liquid drains from the filter cartridge as rapidly as it is collected. Only solid particles will cause a permanent increase in flow resistance; therefore, the useful life of the filter is determined only by the quantity of solids in the gas.

## How to obtain a trouble-free coalescer...

The mechanism of coalescing leads to two important considerations in selecting and installing a coalescing filter:

- I. Proper sizing of a Parker coalescing filter is easily done by using the maximum flow rate data in the charts (page 18).
- II. To avoid liquid carryover, the coalesced liquid should not be allowed to build up in the filter housing above the level of the bottom of the filter cartridge. Rather than relying on operator attention to this easily overlooked job, automatic drains should be installed with all coalescing filters.

## ISO 8573.1 QUALITY CLASSES

Quality Class	Dirt Particle Size in Micron	Water Pressure dew point °C (ppm. vol.) at 7 barg	Oil (Including vapour) mg/m <sup>3</sup>
1	0.1	-70 (0.3)	0.01
2	1	-40 (16)	0.10
3	5	-20 (128)	1.00
4	15	+3 (940)	5.00
5	40	+7 (1,240)	25.00
6	-	+10 (1,500)	-

### GENERAL PURPOSE PROTECTION

General ring main protection  
Pre-filtration for refrigeration type air dryers  
Liquid and solid - bulk contamination removal  
Pre-filtration to high efficiency filters

Particle removal only in 'dry systems'  
Pre-filtration to adsorption type air dryers in 'oil free' systems  
Large pneumatic tools  
Low cost automation  
Pre-filtration to air sterilisation filters in 'oil-free' systems

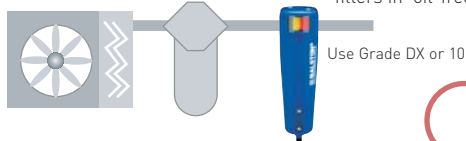

**ISO 8573.1  
Class 2.-.3**

### REDUCED DEW POINT SYSTEM

Where dew point is not required to be less than 2°C.

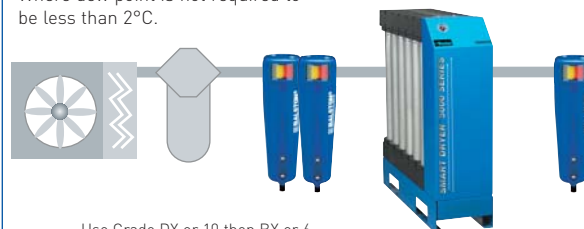

Use Grade DX or 10 then BX or 6 (finally 000 or A for critical applications)

SMD Membrane Air Dryer

**ISO 8573.1  
Class 1.4.1**

### 'OIL FREE' AIR

'Oil-free' air  
Pipeline purging  
Robotics  
Temperature control systems  
Air logistics  
Pre-filtration to adsorption type air dryers in oil contaminated systems  
Fine pneumatic tools

Pre-filtration to air sterilisation filters in oil contaminated systems  
Instrumentation  
Spray painting  
Air gauging  
Air conveying  
Air bearings  
Air motors



**ISO 8573.1  
Class 1.-.2**

### EXTREMELY LOW DEW POINT SYSTEM

Where totally dry compressed air is required with a dew point of -40°C.  
To stop corrosion from compressed air at 20°C and 7barg.

A -30°C dew point is the minimum requirement.



Use Grade DX or 10 then BX or 6 (finally 000 or A for critical applications)

Point-of-Use Membrane Air Dryer

**ISO 8573.1  
Class 1.2.1**

### CRITICAL APPLICATIONS

Highest quality - clean, oil and odour free air  
Decompression chambers  
Cosmetic production  
Foodstuffs  
Dairies-  
production/packaging/transport

Production/packaging blow moulding of plastics e.g. p.e.t. bottles  
Film processing  
Breweries-  
production/packaging/transport  
Critical instrumentation  
Advanced pneumatics  
Air-blast circuit - breakers

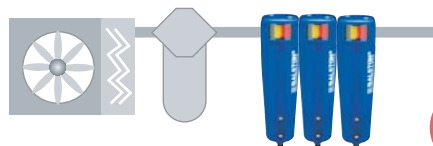

Use Grade DX or 10 then BX or 6 finally 000 or A

**ISO 8573.1  
Class 1.-.1**

**For other applications and help with your specific requirements, contact Technical Support on +44 (0)1622 723 300**

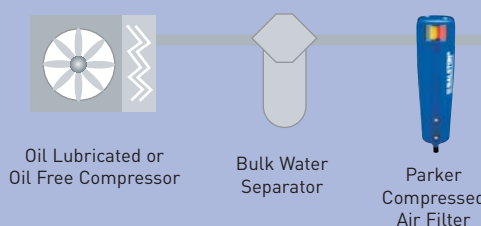

# Filtration Media Grades Specifications

## 2000-series, 6000-series and 914 series Coalescing Filter Media

### Grade BXE:

Applications: General air coalescing applications when total removal of liquid aerosols and suspended fines is required in all pressure ranges. Protection of air dryers, air gauging, air logic, modulating systems, critical air conveying, most breathing air systems, etc.

### Grade DXE:

Applications: Precoalescer or prefilter for Grade 6 to remove gross amounts of water and oil, or tenacious aerosols which are difficult to remove. Upgrading existing particulate equipment to coalescing without increase in pressure drop.

Grade Designation	Efficiency for 0.01 micron particles and droplets	Pressure Drop (bar) @ Rated Flow Media Dry
DXE	93%	0.14
BXE	100%	0.14

**Temperature Range:** -30°C up to +149°C

**Materials of construction:** Borosilicate glass microfibrils with fluorocarbon resin binder. Resistant to water, all hydrocarbon and synthetic lubricants.

### Sterile Air Filter Media:

#### Grade SA:

Applications: Grade SA filter removes bacteria from compressed air and is the final filter in a sterile air system. SA media must have BXE prefilter.

Grade Designation	Efficiency for 0.01 micron particles and droplets	Pressure Drop (bar) @ Rated Flow Media Dry
SA	99.9999%+	0.5

**Temperature Range:** -30°C up to +149°C

**Materials of construction:** Borosilicate glass microfibrils with fluorocarbon resin binder. Resistant to water, all hydrocarbon and synthetic lubricants

### Adsorption (Vapour Removal) Filter Media:

#### Grade 000:

Applications: Polishing gas stream of final trace amounts of hydrocarbon contaminants, usually 0.5 to 2 ppm inlet concentrations. Preparation for breathing air; hydrocarbon removal.

Grade Designation	Oil Vapour Removal Efficiency	Pressure Drop (bar) @ Rated Flow Media Dry
000	99%+	0.14

**Temperature Range:** Max. temp. 80°C.

**Materials of construction:** Activated Carbon.

## Q-series, BA series, ZT-series, ZF-series media specifications

### Coalescing Filter Media

#### Grade 6C:

Applications: General air coalescing applications when total removal of liquid aerosols and suspended fines is required in all pressure ranges. Protection of air dryers, air gauging, air logic, modulating systems, critical air conveying, most breathing air systems, etc.

#### Grade 10C:

Applications: Precoalescer or prefilter for Grade 6 to remove gross amounts of water and oil, or tenacious aerosols which are difficult to remove. Upgrading existing particulate equipment to coalescing without increase in pressure drop.

Grade Designation	Coalescing Efficiency 0.3 to 0.6 micron particles	Maximum Oil Carryover PPM w/w (1)	Micron Rating	Pressure Drop (bar) ' @ Rated Flow (2)	
				Media dry	Media wet with 10-20 wt. oil
6	99.97%	0.008	0.01	0.07	0.14 - 0.20
10	95%	0.85	1	0.035	0.035

#### Notes:

(1) Tested per ADF-400 at 40 ppm inlet.

(2) Add dry + wet for total pressure drop.

**Temperature Range:** -30°C up to +149°C

**Materials of construction:** Borosilicate glass microfibrils with fluorocarbon resin binder. Resistant to water, all hydrocarbon and synthetic lubricants

### Water Separator Filter Media

#### 100WS:

Applications: Reduction and elimination of excess liquids in gas streams. Excellent prefiltration for coalescing grades 6 and 10 when extreme quantities of liquid contaminants are present.

Grade Designation	Filter Efficiency Rating	Pressure Drop (bar) @ Rated Flow Media Dry
100WS	100µm	<0.02

**Notes:** Element flows in to out.

**Temperature Range:** Max. temp. 80°C.

**Materials of construction:** Rolled stainless steel mesh (304 SS).

### Interceptor (Particulate Removal) Filter Media

#### 3PU

Applications: Particulate removal where very high dirt-holding capacity is require. Safety after filter for desiccant dryer, pore matched prefilter for coalescer or as general use for the final instrument air protection.

Grade Designation	Filter Efficiency Rating	Pressure Drop (bar) @ Rated Flow Media Dry
3PU	3µm	<0.02

**Temperature Range:** Max. temp. 80°C.

**Materials of construction:** Pleated cellulose.

### Adsorption (Vapour Removal) Filter Media

#### A

Applications: Polishing gas stream of final trace amounts of hydrocarbon contaminants, usually 0.5 to 2 ppm inlet concentrations. Preparation for breathing air; hydrocarbon removal.

Grade Designation	Oil Vapour Removal Efficiency	Pressure Drop (bar) @ Rated Flow Media Dry
A	99%+	0.07

**Temperature Range:** Max. temp. 80°C.

**Materials of construction:** Activated Carbon.

# Filter Silencers

## Exhaust Coalescers and Silencers

### Features

- Longer life and less back pressure than sintered designs
- Remove all visible oil mist from exhaust air
- Exceptionally efficient silencers for air exhausts
- Available for exhaust ports from 1/8" to 1"



Type 9955-05-DX   Type 9955-11-DX   Type 18/18-DX   Type ECSB-4  
and 9955-12-DX

### Types 9955-05-DX, 9955-11-DX, 9955-12-DX, 18/18-DX and ECSB-4

Balston Filter/Silencers are remarkably efficient sound mufflers, far more efficient than the felts, pleated paper, sintered plastic and sintered metal products commonly used in other exhaust silencers. A sound attenuation efficiency test comparing a 9955-12-DX, 1/2" Filter/Silencer with a sintered polyethylene silencer is described below.

This silencing efficiency test simulates the action of an air cylinder discharging rapidly to atmosphere. A length of 1/2" line between two ball valves is pressurised with air to a controlled pressure. The upstream valve is closed and then the downstream valve is opened rapidly to discharge the fixed volume of air under pressure to atmosphere. Noise levels were measured at a 0.75 metre distance, firstly with no silencer on the end of the line, secondly with the Balston Filter/Silencer and lastly with competitive silencer.

Noise Level (dBA)	Upstream Pressure (barg)				
	7	5.5	4.3	2.7	1.5
<b>With Balston Silencer</b>	70	70	69	67	65
<b>With Sintered Polyethylene Silencer</b>	88	88	87	87	81

A similar test of the Type 18/18 on a 3/4" air line gave the following results:

Sound Level 1m from 3/4" Air Line Discharging Air At 7 barg to Atmosphere	
<b>Without Silencer</b> 113 dBA	<b>With Type 18/18-DX</b> 94 dBA

### Principal Specifications

Type	9955-05-DX	9955-11-DX	9955-12-DX	18/18-DX	ECSB-4
<b>Inlet Port</b>	1/8" NPT (Male)	1/4" NPT (Male)	1/2" NPT (Male)	3/4" NPT (Female)	1" NPT (Female)
<b>Drain Port</b>	1/4" OD Stem (6mm ID Tube)	1/4" OD Stem (6mm ID Tube)	1/4" OD Stem (6mm ID Tube)	1/8" NPT (Female)	1/4" ID Tubing (6mm 1/4 ID)
<b>Materials of Construction</b>					
<b>Filter Cartridge</b>	Borosilicate glass microfibres with fluorocarbon resin binder				
<b>Holder</b>	Nylon	Nylon	Nylon	Steel	Nylon
<b>Internals</b>	—	—	—	Steel	—
<b>Maximum Internal Pressure at 43°C</b>	7 barg	7 barg	7 barg	7 barg	7 barg
<b>Maximum Temperature at 0 barg Internal Pressure</b>	127°C	127°C	127°C	149°C	52°C
<b>Shipping Weight</b>	0.2kg	0.2kg	0.2kg	0.5kg	0.5kg
<b>Dimensions</b>	40x50mm	40x80mm	50x90mm	90x140mm	185x65mm

### Ordering Information

Type	Description
9955-05-DX, 9955-11-DX and 9955-12-DX	Standard Pack of 10 Filter/Silencers per box, individually wrapped
18/18-DX	One Type 18/18-DX per box
ECSB-4	One Type ECSB-4 per box



**Parker Hannifin**

Hermitage Court, Hermitage Lane, Maidstone, Kent ME16 9NT, England

Phone: +44 (0)1622 723 300 Fax: +44 (0)1622 728 703 E-mail: [pagsservicesupport@parker.com](mailto:pagsservicesupport@parker.com) Web site: [www.parker.com/pag](http://www.parker.com/pag)

# Compressed Air Filters

## Miniature Point-of-Use Filters

### Features

**Remove up to 99.99% of 0.01 micron oil, water and dirt**

**Automatic drain options**

**Maximum temperature to 121°C**

**Maximum pressure to 17 barg**

### Types A914D, A914P, A914, A914A

Types A914P and A914D are 1/4" line size assemblies with simple, reliable drains used for low flow applications with moderate levels of liquid contaminate.

The A914P is designed to empty condensate when there is a sudden pressure drop through the system (intermittent compressed air demand applications). The A914D incorporates an overnight drain which will drain liquid contaminate when the compressed air system pressure drops below 0.35 barg. The standard A914 utilizes a standard manual threaded drain. Types A914D, A914P and A914 have a transparent polycarbonate bowl with an aluminium head.

The Type A914A has an aluminium bowl and head.



Type A914



Type A914A



Type A914D



Type A914P,

### Principal Specifications

Type	A914, A914A, A914D, A914P
Port Size	1/4" BSPT
Materials of Construction	
Head	Anodised Aluminium
Bowl	Polycarbonate/Anodised Aluminium
Internals	Nylon
Seals	Buna-N
Maximum Temperature	49°C <sup>[3]</sup>
Maximum Pressure <sup>[1]</sup>	10 barg <sup>[4]</sup>
Minimum Pressure <sup>[2]</sup>	0.35 barg
Shipping Weight	0.2kg
Dimensions	40 x 100mm

### Ordering Information

Type	A914, A914A, A914D, A914P
Differential Pressure Indicator	Not Included
Replacement Filter Cartridges	
No. Required	1
Box of 5	5/050-05-□
Box of 10	050-05-□

#### Notes:

1. Maximum pressure ratings are for temperatures to 49°C. Please consult factory for maximum pressure ratings at elevated temperatures.
2. Required for proper operation of piston drain, overnight drain.
3. Aluminium version maximum temperature is 120°C.
4. Aluminium version maximum pressure is 17 barg.
5. A914D for overnight drain, A914P for piston drain, A914A for aluminium version.

# Filters with Aluminium Heads and Plastic Bowls

## Features

Lightweight and economical

Pressure up to 9 barg

Aluminium heads

The Q series is an excellent point-of-use filter where element visibility is required. Coalescing, particulate and adsorption elements are available.

The Q series consists of aluminium head and clear polyurethane bowl design. Porting in NPT and BSPF is standard with an operating pressure to 9 barg.



QN15N/Q2N Series

## Principal Specifications

Housing Model Number:	QN-15N-1GN	QN-15N-1SN	QN-15N-1HN	QN-15N-1CN	QN-15N-1CUN	QN-15N-1AUN	QN-15N-3PUN	QN-15N-1QUN	QN-2N-1GN	QN-2N-1SN	QN-2N-1HN	QN-2N-1CN	QN-2N-1CUN	QN-2N-1AUN	QN-2N-3PUN	QN-2N-1QUN
Port Size (NPT)	3/8"	3/8"	3/8"	3/8"	3/8"	3/8"	3/8"	3/8"	1/2"	1/2"	1/2"	1/2"	1/2"	1/2"	1/2"	1/2"
Element End Seals	No End Seals				Urethane				No End Seals				Urethane			
Max. Pressure	9 barg															
Max. Temp	52°C															
Materials:																
Head	Aluminium															
Bowl	Clear Polyurethane															
Internals	Stainless Steel/Acetal Plastic															
O-Rings	Buna N															
Shipping Wt.	0.38 kg															

## How to Order

Use the matrix below to specify what filter assembly you require.

QN

Port Size

1 - 1/4"

15 - 3/8"

2 - 1/2"

Thread

N

NPT

F

BSPF

Media Grade

blank for 3PU, AU

2

4

6

8

10

Media Type

G

T

F

H

C

CU

QU

3PU

AU

ACCESSORIES

N

None

D

Differential Pressure Indicator

G

Differential Pressure Gauge

For example: QN15N-10QUN for complete assembly, including element. QN15NN x for an empty housing.

Note: Although the element size is not included in the part number construction for this filter, the size, 10-025, is needed to order replacement elements. For example. 6C 10-025 x 8.

Parker Hannifin

Hermitage Court, Hermitage Lane, Maidstone, Kent ME16 9NT, England

Phone: +44 (0)1622 723 300 Fax: +44 (0)1622 728 703 E-mail: [pagsservicesupport@parker.com](mailto:pagsservicesupport@parker.com) Web site: [www.parker.com/pag](http://www.parker.com/pag)

9

S3.2.099a

# Compressed Air Filters

## 1/4" to 1 1/2" Line Size

### Features

- Utilises new XE Energy Saving Elements
- Remove up to 99.9999% of 0.01micron oil, water, dirt and micro-organisms
- Integral filter life indicators
- Automatic drains
- Quick release housings
- Modular fitting
- Site glass to check autodrain operation
- Lifetime warranty<sup>(1)</sup>

### Balston Coalescing Compressed Air Filters

Balston 2000 Series Coalescing Compressed Air Filters protect your equipment and delicate instruments from the dirt, water and oil found in compressed air. Balston Coalescing Filters remove contaminants at very high efficiency – up to 99.9999% for 0.01 micron particles and droplets. Liquid continuously drains from the filter cartridge, which allows the Balston Coalescing Filter to continue removing liquids for an unlimited time, without the loss of efficiency, flow capacity or pressure drop.

#### What's Creating The Cost?

For every 0.1 bar (2 psi) of differential pressure in a compressed air system, the energy requirement of the compressor is increased by 1% [Source: CAGI].

#### What's The Savings Solution?

The new "XE-Cartridges" from Parker exhibit a <0.1 bar (<2 psi) pressure drop improvement over the current generation cartridge. This produces cost savings of up to 379 EUR per year per installed filter cartridge depending on the number of work shifts.\*

#### How Do I Order Them?

All 2000-series will include the XE type media (with no change in part number). For cartridge replacements be sure

to order the NEW "XE-Cartridges". Just simply add an "E" for energy savings to the end of the part number, see example below.

**Previous Part #**  
**100-18-DX**

**New Part #**  
**100-18-DXE**

\* Based on 14.86 euro / 100 Kwh as a European average electrical cost [Source: CIDEM, based on data provided by Eurostat ("Statistics in Focus", Environment and Energy)]. Savings are more significant in higher cost countries.

#### MODULAR FITTING

allows filters to be mounted with the minimum disruption and in the smallest space

#### INTEGRAL DIFFERENTIAL PRESSURE INDICATOR

back and front allowing all round visibility and ensuring optimum filter element change

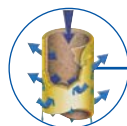

#### BALSTON HIGH EFFICIENCY ELEMENT

0.01 micron removal of oil, water and dirt. Superior protection with lowest consumable cost



#### BAYONET CLOSURE

minimal maintenance time with less wear and tear



#### ERGONOMICALLY DESIGNED TOUGH POWDER COATED ALUMINIUM BOWL



#### SIGHT GLASS

easy to check oil and water level

### Filter Element Description

#### Bulk Water Removal

For the reduction and elimination of excess liquids in gas streams. Excellent prefiltration for coalescing filters when extreme quantities of liquid contaminants are present. Use grade 100WS – contact Parker for further details.

#### General Purpose Applications Such as Plant Compressed Air Instrument Air and Other Critical Air Requirements

Single stage filtration. Use a Grade DXE filter.

Two stage filtration is necessary. Use a Grade DXE followed by a Grade BXE filter. As a general rule, a Grade BXE filter should not be used alone.

#### Removal of Trace Compressor Oil Vapour

For rare instances where even a trace amount of oil vapour can cause a problem, three stage filtration is necessary. Use a Grade DXE followed by a Grade BXE and a Type CI cartridge.

#### Commercially Sterile Air

3-Stage filtration is necessary. Use a grade BXE followed by a CI and a SA cartridge.

## Principal Specifications

Type	2002	2003	2004	2104	2206	2208	2312
<b>Port Size</b>	1/4"	3/8"	1/2"	1/2"	3/4"	1"	1 1/2"
<b>Materials of Construction</b>							
<b>Head</b>	Aluminium	Aluminium	Aluminium	Aluminium	Anod. Alum.	Anod. Alum.	Anod. Alum.
<b>Bowl</b>	Aluminium	Aluminium	Aluminium	Aluminium	Steel	Steel	Steel
<b>Internals</b>	Nylon	Nylon	Nylon	Nylon	St. Steel	St. Steel	St. Steel
<b>Seals</b>	Buna-N	Buna-N	Buna-N	Buna-N	Buna-N	Buna-N	Buna-N
<b>Maximum Temperature<sup>(2)</sup></b>	54°C	54°C	54°C	54°C	54°C	54°C	54°C
<b>Maximum Pressure<sup>(3)</sup></b>	17 barg	17 barg	17 barg	17 barg	17 barg	17 barg	17 barg
<b>Minimum Pressure<sup>(4)</sup></b>	1 barg	1 barg	1 barg	1 barg	1 barg	1 barg	1 barg
<b>Shipping Weight</b>	1.1 kg	1.1 kg	1.1 kg	1.9 kg	3.6 kg	3.6 kg	6.8 kg
<b>Dimensions</b>	80 x 200mm	80 x 200mm	80 x 200mm	80 x 280mm	100 x 330mm	10 x 330mm	130 x 430mm

## Ordering Information

Type	2002	2003	2004	2104	2206	2208	2312
<b>Filter Cartridges</b>							
<b>No. Required</b>	1	1	1	1	1	1	1
<b>Box of 5<sup>(5)</sup></b>	5/100-12-□	5/100-12-□	5/100-12-□	5/100-18-□	5/150-19-□	5/150-19-□	5/200-35-□
<b>Box of 10<sup>(5)</sup></b>	100-12-□	100-12-□	100-12-□	100-18-□	150-19-□	150-19-□	200-35-□
<b>CI Cartridge</b>							
<b>Box of 1<sup>(7)</sup></b>	CI100-12-000	CI100-12-000	CI100-12-000	CI100-25-000	CI150-19-000	CI150-19-000	CI200-35-000

## How to Order the Filter Assembly Part Numbers

Use the matrix below to specify what filter assembly you require.

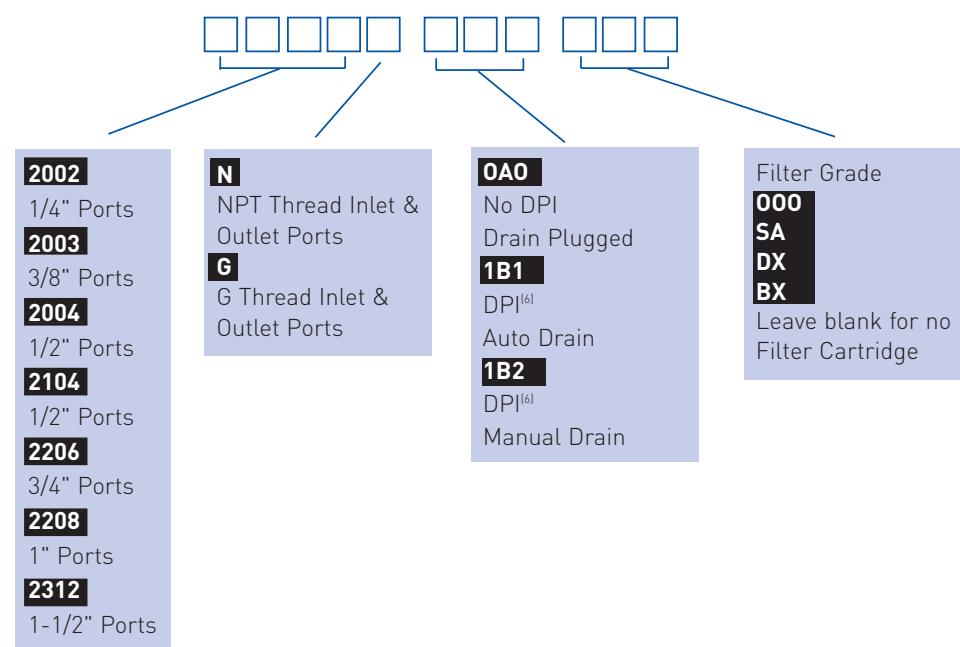

### Notes:

- 1 Lifetime (20 year) Warranty included. Contact your local representative for details.
- 2 Automatic Drain and Differential Pressure Indicator are limiting factors. For temperature capabilities to 104°C, order assemblies without Auto Drain and Differential Pressure Indicator.
- 3 Maximum pressure ratings are for temperatures to 54°C. Please consult factory for maximum pressure ratings at elevated temperatures.
- 4 Required for proper operation of the float drain.
- 5 Indicate grade of filter cartridge by putting appropriate letter after ordering number. Example: 5/150-19-DXE, 200-35-BXE.
- 6 The DPI is sensitive in the range of 0-5 psi differential.
- 7 Automatic drains not supplied with assemblies containing Type CI cartridges.

**Example:** 1/2" NPT filter with DPI and Auto Drain with Grade DX Filter = 2104N-1B1-DX

# Compressed Air Filters

## 2" to 3" Line Size

### Features

Differential pressure gauges allow optimum element change-outs

External automatic drain supplied

Flow rates to 5,644m<sup>3</sup>/h (3,320SCFM)

All Aluminium construction, with a tough chromated and powder paint finish

### Parker ZT-Series Compressed Air Filters

Parker ZT-Series compressed air filters protect your equipment and delicate instruments from the dirt, water and oil found in compressed air. ZT-Series housings are available with oil and water removal (coalescing), particulate and oil vapour removal elements.

ZT-Series housings have a maximum pressure to 16 barg, and port sizes to 3" giving a maximum flow rate of 5,644m<sup>3</sup>/h (3,320SCFM). An all aluminum construction with a tough powder paint finish provides a rugged construction offering a long life.



### Principal Specifications

Port Size	ZT14 2"	ZT17 2"	ZT18 2 1/2"	ZT19 3"
<b>Materials of Construction</b>				
Head	Aluminium	Aluminium	Aluminium	Aluminium
Bowl	Aluminium	Aluminium	Aluminium	Aluminium
Seals	Nitrile	Nitrile	Nitrile	Nitrile
Maximum Temperature	79°C	79°C	79°C	79°C
Maximum Pressure	16 barg	16 barg	16 barg	16 barg
Shipping Weight	9.6 Kg	12.3 Kg	24.6 Kg	27 Kg
Dimensions	164x825mm	164x1075mm	250x1050mm	250x1200mm
Additional length for Bowl removal	520mm	770mm	600mm	750mm

### Ordering Information

Element Grade	ZT14	ZT17	ZT18	ZT19
6C	6CZ27-200	6CZ27-298	6CZ46-239	6CZ50-298
10C	10CZ27-200	10CZ27-298	10CZ46-239	10CZ50-298
3P	3PZ27-200	3PZ27-298	3PZ46-239	3PZ50-298
A	AZ27-200	AZ27-298	AZ46-239	AZ50-298
100WS	100WSZ27-200	100WSZ27-298	100WSZ46-239	100WSZ50-298

### How to Order the Filter Assembly Part Numbers

Use the matrix below to specify what filter assembly you require.

Z	T		016	
		Port Size	016 (16 bar)	Element Grade and Element Type
		14 or 17	Standard Pressure	6 C Coalescer
		2" G (BSP)		10 C Coalescer
		18	*Contact Parker for other pressures	3 P Pleated Cellulose
		2 1/2" G (BSP)		100 WS Water Separator
		19		* A Absorber
		3" G (BSP)		*Leave first column blank for absorber
				As Standard
				External Auto
				Drain and
				Differential
				Pressure Gauge

# Compressed Air Filters

## DN 100 - DN 200

### Features

Porting up to DN200 flange

Flows to 22,828m³/h

Large sump capacity

Easy element replacement

### General Description

Parker's large capacity coded filter vessels have been designed specifically for our coalescing elements and incorporate large sump capacities and generous exit cavities for maximum performance with low differential pressures.

With flow capacities to 22,828m³/h and pressure to 16 barg and optional materials of construction, most compressor source filtration requirements can be met.



### Principal Specifications

Housing Assembly Port Size	ZF20-016 DN100	ZF30-016 DN100	ZF40-016 DN150	ZF60-016 DN150	ZF80-016 DN200	ZF100-016 DN200
<b>Materials of construction</b>						
<b>Head</b>	Carbon Steel	Carbon Steel	Carbon Steel	Carbon Steel	Carbon Steel	Carbon Steel
<b>Bowl</b>	Carbon Steel	Carbon Steel	Carbon Steel	Carbon Steel	Carbon Steel	Carbon Steel
<b>Seals</b>	Nitrile	Nitrile	Nitrile	Nitrile	Nitrile	Nitrile
<b>Maximum Temperature</b>	79°C	79°C	79°C	79°C	79°C	79°C
<b>Maximum Pressure</b>	16 barg	16 barg	16 barg	16 barg	16 barg	16 barg
<b>Shipping Weight</b>	106	106.5	148	208	230	366
<b>Dimensions (mm)</b>	500 x 1440	500 x 1440	640 x 1590	790 x 1650	790 x 1730	840 x 1780
<b>Additional length for bowl removal (mm)</b>	550	550	550	550	550	550
<b>Number of Elements per housing</b>	2	3	4	6	8	10

Housing	Element Grade and Type	Element Size	Number of Elements
<b>ZF20</b>	6C, 10C, 3P, A, 100WS	Z27-298	2
<b>ZF30</b>	6C, 10C, 3P, A, 100WS	Z27-298	3
<b>ZF40</b>	6C, 10C, 3P, A, 100WS	Z27-298	4
<b>ZF60</b>	6C, 10C, 3P, A, 100WS	Z27-298	6
<b>ZF80</b>	6C, 10C, 3P, A, 100WS	Z27-298	8
<b>ZF100</b>	6C, 10C, 3P, A, 100WS	Z27-298	10

Element	Dry (bar)	Wet (bar)
<b>6C</b>	0.07	0.21 - 0.28
<b>10C</b>	0.03	0.07 - 0.10
<b>3P</b>	0.02	N/A
<b>100WS</b>	≤0.02	≤0.02
<b>A</b>	0.07	N/A

#### Examples:

ZF20 housing with grade 10C element: replacement part number = 10CZ27-298 (2 pieces per housing)

ZF80 housing with grade 3P element: replacement part number = 3PZ27-298 (8 pieces per housing)

**Z**

**F**

**016**

**016**

**016**

DN  
20  
30  
40  
60  
60  
100

#### 016

Standard Pressure

\*Contact Parker for other pressures

#### Element Grade and Element Type

**6 C** Coalescer  
**10 C** Coalescer  
**3 P** Pleated Cellulose  
**100 WS** Water Separator  
**\* A** Absorber

\*Leave first column blank for absorber

As Standard  
External Auto Drain and Differential Pressure Gauge



Parker Hannifin

Hermitage Court, Hermitage Lane, Maidstone, Kent ME16 9NT, England

Phone: +44 (0)1622 723 300 Fax: +44 (0)1622 728 703 E-mail: [pagsservicesupport@parker.com](mailto:pagsservicesupport@parker.com) Web site: [www.parker.com/pag](http://www.parker.com/pag)

# Stainless Steel Filters for Compressed Air

## Ideal for pulp mills, steel and metal fabrication plants, refineries and chemical plants

Balston Stainless Steel Filters protect your equipment and delicate instruments from the dirt, water and oil usually found in compressed air and other gases. These filters will remove contaminants at a very high efficiency - up to 99.99% for 0.1 micron particles and droplets. Liquid releases from the filter cartridge to an automatic drain as rapidly as it enters the filter. This allows the filter to continue removing liquids for an unlimited time without loss of efficiency or flow capacity. Select 1/4" to 1" line filters are constructed of 304 stainless steel and are designed to hold up to the harshest environments.

### Features

**All 304 stainless steel construction, ideal for harsh environments: food processing plants, chemical plants, refineries, pulp mills.**

**Remove 99.99% of 0.01 micron particles of oil, water and dirt from compressed air and other gases**

**Continuously trap and drain liquids**

**Remove trace oil vapour with adsorbent cartridges**



Balston grade SA filter cartridges, rated at 99.9999+% efficiency for 0.01 micron particles, is at least 30 times better than the accepted standard for sterile air filters developed by independent research organisations in the U.S. and U.K. (request bulletin T1-105A for a detailed discussion on Balston filter efficiency rating procedure and Bulletin T1-935 for an independent test report on Balston Sterile Air Filters). Balston Sterile Air Filters are in full compliance with the requirements of the FDA.

### Steam Sterilisation Procedure

In installations where the sterile air filter requires steam sterilisation, we recommend the following procedures:

The steam sterilisation pressure should not exceed 4 barg. Preferably, it should be held to 3 barg or less. A typical sterilisation cycle is 2 barg steam for 30 minutes. Steaming time can be increased as desired without harm to the filter cartridges. The steam flow should not exceed the normal air flow for the unit. To ensure no build up of condensate in the housing, condensate should be drained from the filter by a condensate drain valve during the steaming process. The cleanliness of the steam is an important factor influencing the life of the Sterile Air Filter cartridges. Parker strongly recommends using Model 23 Steam Filters to ensure optimum operating life (see page 36). When autoclaving, the Grade SA filter cartridges will tolerate temperatures to 149°C in dry gas. Viton® or other heat resistant seals should be used in the housing.

Viton® is a registered trademark of Dupont Dow Elastomers.

### Model 6002

The 6002 series models are 1/4" line size filters designed for lower flow systems and installations with space limitations. It is offered with two drain options, a manual drain or an auto float drain for maintenance free operation.

### Model 6004

The 6004 series models are 1/2" line size filters designed for moderate flow rate systems. This series has increased liquid holding capacity which safeguards sensitive end use points from system upsets and morning start ups.

### Model 6006 and 6008

The 6006 and 6008 series models are 3/4" and 1" line size filters respectively. These are designed for high flow rate systems servicing multiple end use points. These are also offered with a high capacity auto float drain option.

## Principal Specifications

Model	6002N	6004N	6006N	6008N
<b>Port Size</b>	1/4" NPT	1/2" NPT	3/4" NPT	1" NPT
<b>Materials of Construction</b>				
<b>Head</b>	304 Stainless Steel	304 Stainless Steel	304 Stainless Steel	304 Stainless Steel
<b>Bowl</b>	304 Stainless Steel	304 Stainless Steel	304 Stainless Steel	304 Stainless Steel
<b>Internals</b>	Nylon	Nylon	Stainless Steel	Stainless Steel
<b>Seals</b>	Buna-N Food Grade	Buna-N Food Grade	Buna-N Food Grade	Buna-N Food Grade
<b>Maximum Temperature (1)</b>	49°C	49°C	49°C	49°C
<b>Maximum Pressure (2)</b>	12 barg	12 barg	12 barg	12 barg
<b>Minimum Pressure (3)</b>	1 barg	1 barg	1 barg	1 barg
<b>Shipping Weight</b>	1.6 kg	1.8 kg	5 kg	5.5 kg
<b>Dimensions</b>	7 x 18mm	7 x 25mm	10 x 25mm	10 x 30mm

### Notes:

1 Max. temperature with auto drain. Max. temperature with manual drain is 135°C. 2 Max. pressure with auto drain. Max. pressure with manual drain is 17 barg  
3 Required for proper operation of auto drain.

## Replacement Filter Cartridge Ordering Information

Model P/N	6002	6004	6006	6008
<b>Replacement Filter Cartridges</b>				
<b>Number required</b>	1	1	1	1
<b>Box of 5</b>	5/100-12-[*X]E	5/100-18-[*X]E	5/200-176-[*X]E	5/200-185-[*X]E
<b>Box of 10</b>	100-12-[*X]E	100-18-[*X]E	200-176-[*X]E	200-185-[*X]E
<b>Box of 10</b>	100-12-SA	100-18-SA	200-176-SA	200-185-SA
<b>CI Cartridges (box of 1)</b>	CI100-12-000	CI100-18-000	CI200-176-000	CI200-185-000

(\*replace with B or D)

## Ordering Information

<input type="checkbox"/>	<input type="checkbox"/>	<input type="checkbox"/>	<input type="checkbox"/>	<b>N</b>	<input type="checkbox"/>	<input type="checkbox"/>	<input type="checkbox"/>	<input type="checkbox"/>	<input type="checkbox"/>	<input type="checkbox"/>
<b>6002</b>	1/4" Ports			NPT Thread Inlet & Outlet Ports	<b>0A2</b>	Manual Drain			<b>Filter Grade</b>	
<b>6004</b>	1/2" Ports				<b>0A1</b>	Auto Drain			<b>000</b>	
<b>6006</b>	3/4" Ports								<b>SA</b>	
<b>6008</b>	1" Ports								<b>DX</b>	
									<b>BX</b>	
									Leave blank for no filter cartridge	

### How to order the Filter Assembly

Build your own custom filter assembly using the guideline matrix (left) and specify your model number.

Example:

1/2" filter and Auto Drain with Grade DXE Filter = 6004N-0A1-DX.

## Flow Rates m<sup>3</sup>/hr at 0.14 barg drop at indicated line pressure.

Filter Housing Model	Port Size	Filter Cartridge Grade	Barg	0.14	1.4	3	6	7	9	10	14	17
<b>6002N</b>	1/4"	DXE		15	32	66	87	107	129	153	199	246
		BXE		5	14	19	36	42	53	61	80	99
		CI		3	8	12	20	25	31	37	48	59
		SA		-	14	19	36	42	53	61	-	-
<b>6004N</b>	1/2"	DXE		32	70	110	192	233	282	333	437	537
		BXE		15	32	51	87	107	129	153	199	246
		CI		10	20	32	54	66	82	95	124	153
		SA		-	32	51	87	107	129	153	-	-
<b>6006N</b>	3/4"	DXE		63	133	209	364	440	535	630	822	1013
		BXE		17	36	58	95	119	144	172	223	275
		CI		14	27	44	75	90	110	129	168	207
		SA		-	36	58	95	119	144	172	-	-
<b>6008N</b>	1"	DXE		93	195	308	533	646	787	928	1208	1490
		BXE		19	39	63	109	131	160	189	245	302
		CI		17	34	54	95	114	139	163	212	262
		SA		-	34	70	116	144	177	209	-	-

# Dual-Stage Filters for Breathing Air and Food Quality

## Features

**Connection Sizes to 1"**

**Flows up to 127 m<sup>3</sup>/h (75 SCFM)**

**Maximum pressure 34 barg (500 psig)**

**Maximum temperature 79°C (175°F)**

**1/8" drain port with manual drain as standard**

## General Description

BA-series filters are designed to be used as point-of-use breathing air filters. The BA-series combination unit contains both a fine grade coalescing filter element and an activated carbon vapour removal element.

In addition to breathing air the BA-series filters may also be used in applications requiring compressed air to be free of odour or taste bearing hydrocarbons e.g. food contact. Replacement elements are supplied in a convenient repair kit. The kit includes one coalescing element, two activated carbon adsorber elements and replacement seals. The kit includes two adsorber elements because the coalescing stage will routinely outlive the extremely sensitive adsorber element.

**THE BA-SERIES WILL NOT REMOVE TOXIC GASES FROM THE AIR STREAM. A CARBON MONOXIDE MONITOR IS RECOMMENDED.**

## How to Order Complete Dual-Stage Assemblies

<b>BA</b>						<b>U</b>	
Series Name	Port Type	Port Connection Size	Bowl	Element Grade	Element Type	End Seal	Accessory Designator for preinstalled accessories
	<b>N</b> NPT <b>F-G</b> Thread	<b>1</b> 1/4" <b>15</b> 3/8" <b>2</b> 1/2" <b>3</b> 3/4" <b>4</b> 1"	<b>L</b> Long <b>S</b> Standard <small>(S available on 3/4" and 1" port size only)</small>	<b>4</b> <b>6</b> <small>Note: Designate first stage; grade and media type, second stage; media type will always be "A" media, and is not designated in the part number.</small>	<b>C</b> <b>Q</b>	<b>U</b> Urethane <small>(Standard on all elements)</small>	<b>A</b> Auto Drain <b>D</b> DPI Indicator (1/4" - 1/2" only) <b>G</b> DPG Gauge <b>N</b> No Accessories <b>W</b> A+D (1/4" - 1/2" only) <b>Y</b> A+G

**Note:** Bowl length is determined by the flow rate required. See Flow Rates on page 18.

## How to Order BA-Series Replacement Elements

<b>K</b>	<b>BA</b>					<b>U</b>
Repair Kit	Series Name	Port Connection Size	Bowl	Element Grade	Element Type	End Seal
		<b>1</b> 1/4" <b>15</b> 3/8" <b>2</b> 1/2" <b>3</b> 3/4" <b>4</b> 1"	<b>L</b> Long <b>S</b> Standard <small>(S available on 3/4" and 1" port size only)</small>	<b>4</b> <b>6</b>	<b>C</b> <b>Q</b>	<b>U</b> Urethane <small>(Standard on all elements)</small>

**Note:** Each repair kit contains (1) coalescing element, (2) activated carbon adsorber elements and replacement seals.

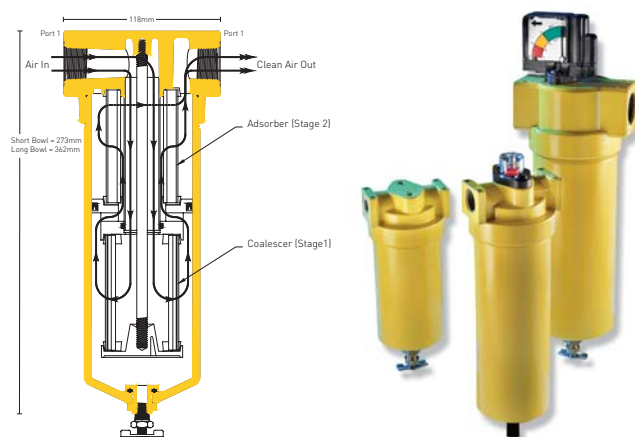

# Medium, High Pressure and Stainless Steel Filters for Gas Filtration

## ZJ-Series

ZJ-Series filters are used in a number of applications, ranging from breathing air for scuba divers, to high-pressure hydraulic circuit testing, to a variety of uses in the alternative fuel industry.

The filter housings and the replaceable elements used in this product line have an extremely robust construction, specially designed for use in system pressures up to 345 barg. Four housing sizes are available with connections ranging from 1/2" to 2"; temperatures up to 176°C and flows up to 66,000 m<sup>3</sup>/hr at 350 barg.

For further technical information please see pages 32 and 33 of Catalogue S3.2.206.

- 1/2" - 2 Line Size
- Pressure Rating 350 bar
- ATEX approved option



## Stainless Steel Filters

Filter elements available for removing oil, water, dirt, gaseous hydrocarbons. Steam and sterile filtration also available.

316 Stainless Steel construction pressures to 345 barg. Temperature to 204°C.

For further technical information please see page 48 of Catalogue S3.2.206.



## Parker Compressed Gas Filters

Parker high flow rate compressed gas filters offer exceptionally high efficiency coalescing filtration of compressed gas at high flow rates. Specifically designed to remove suspended liquids and dirt from pipeline natural gas, the housings are CE PED stamped to 100 barg. Equipped with Parker Finite Filter Cartridges, the filters are rated at 93% retention of 0.01 micron and essentially 100% retention of 1 micron liquid droplets and particles. Since the coalesced liquid drains continuously from the filter cartridges as rapidly as it collected, the filters have an unlimited capacity for liquid removal.

Series ZA are available with inlet and outlet ports covering the range from DN50 to DN200 pipe sizes. The standard carbon steel units have pressure ratings from 16 - 100 barg.

For further technical information please see pages 34 and 35 of Catalogue S3.2.206.

- Pressure rating 100barg
- Flanges to DN200
- 100% retention
- 1 micron droplets and liquids



# Flow Rates

## For Sizing Filter Housings

### m³/h and SCFM

Refer to Principal Specification Charts in each product data sheet for maximum pressure rating of each housing

Filter Housing Type	Filter Grade Element	Flow rates (m³/h), at indicated line pressure (barg)								Flow rates (SCFM), at indicated line pressure (psig)							
Line Pressure		1	3	6	7	9	10	14	17	20	40	80	100	125	150	200	250
A94A, A914, A914D, A914P (1/4") 2002 (1/4"), 2003 (3/8"), 2004 (1/2")	DXE	15	22	41	49	61	73	93	114	9	13	24	29	36	43	55	67
	BXE	4	7	12	14	15	20	25	29	2	4	7	8	9	12	15	17
	DXE	32	66	87	107	129	153	199	246	19	39	51	63	76	90	117	145
	BXE	14	19	36	42	53	61	80	99	8	11	21	25	31	36	47	58
2104 (1/2")	CI	8	12	20	25	31	37	48	59	5	7	12	15	18	22	28	35
	DXE	70	110	192	233	282	333	437	537	41	65	113	137	166	196	257	316
	BXE	32	51	87	107	129	153	199	246	19	30	51	63	76	90	117	145
	CI	20	32	54	66	82	95	124	153	12	19	32	39	48	56	73	90
2206 (3/4")	DXE	133	209	364	440	535	630	822	1013	78	123	214	259	315	371	484	596
	BXE	36	58	95	119	144	172	223	275	21	34	56	70	85	101	131	162
	CI	27	44	75	90	110	129	168	207	16	26	44	53	65	76	99	122
	DXE	195	308	533	646	787	928	1208	1490	115	181	314	380	463	546	711	877
2208 (1")	BXE	39	63	109	131	160	189	245	302	23	37	64	77	94	111	144	178
	CI	34	54	95	114	139	163	212	262	20	32	56	67	82	96	125	154
	DXE	345	542	941	1138	1386	1636	2131	2627	203	319	554	670	816	963	1254	1546
	BXE	78	126	219	263	321	379	493	608	46	74	129	155	189	223	290	358
2312 (1-1/2")	CI	56	88	155	187	228	268	350	430	33	52	91	110	134	158	206	253
	4	6	9	15	17	21	25	32	40	3	5	8	10	12	14	19	23
	6	8	12	20	24	29	35	45	55	4	7	12	14	17	20	26	32
	4	7	10	17	21	25	30	39	48	4	6	10	12	15	17	22	28
BA15L (3/8")	6	9	13	23	28	34	40	51	63	5	8	13	16	19	23	30	37
	4	8	12	20	24	29	35	45	55	4	7	12	14	17	20	26	32
	6	10	15	26	31	38	44	58	71	5	9	15	18	22	26	34	42
	4	13	21	36	43	52	61	80	99	8	12	21	25	30	36	47	58
BA3S (3/4")	6	16	25	43	51	63	74	96	118	9	14	25	30	37	43	56	69
	4	21	33	57	68	83	98	128	157	12	19	33	40	49	57	75	92
	6	31	49	85	102	125	147	191	236	18	29	50	60	73	86	112	138
	4	18	29	50	60	73	86	112	138	11	17	29	35	43	50	66	81
BA4S (1")	6	24	37	64	77	94	110	144	177	14	21	37	45	55	65	84	104
	4	26	41	71	85	104	122	160	197	15	24	41	50	61	72	94	115
	6	39	61	106	128	156	183	239	295	23	36	62	75	91	108	140	173

### Housing Selection Chart ZT and ZF series

Rated Flows: m3/hr @ 7bar and 20°C (SCFM @ 100 psiad 70°F). For other pressures and temperatures please see alternative housing selection below

Housing Assembly	Port Size	Media Grade					
		3P	100WS	10C	6C	A	
ZT14	2"	1526 (898)	1526 (898)	1526 (898)	915 (539)	915 (539)	
ZT17	2"	2283 (1344)	2283 (1344)	2283 (1344)	1370 (806)	1370 (806)	
ZT18	2 1/2"	3058 (1800)	3058 (1800)	3058 (1800)	1920 (1130)	1920 (1130)	
ZT19	3"	4027 (2370)	4027 (2370)	4027 (2370)	2416 (1422)	2416 (1422)	
ZF20	DN 100	4566 (2687)	4566 (2687)	4566 (2687)	2739 (1612)	2739 (1612)	
ZF30	DN 100	6848 (4031)	6848 (4031)	6848 (4031)	4109 (2418)	4109 (2418)	
ZF40	DN 150	9131 (5374)	9131 (5374)	9131 (5374)	5479 (3225)	5479 (3225)	
ZF60	DN 150	13697 (8062)	13697 (8062)	13697 (8062)	8218 (4837)	8218 (4837)	
ZF80	DN 200	14942 (100749)	14942 (100749)	14942 (100749)	10957 (6449)	10957 (6449)	
ZF100	DN 200	22828 (13436)	22828 (13436)	22828 (13436)	13697 (8062)	13697 (8062)	

### Alternative Housing Selection Chart

for applications with conditions other than 7 bar and 20°C (standard conditions)

#### Converting Actual Application Conditions to Standardised Conditions

As the required size of the filter is affected not only by flow but also by operating pressure and operating temperature, it is necessary to convert those actual conditions to standardised conditions (7 bar and 20°C). The calculated adjusted flow rate can be used to choose the appropriate filter in the chart above. When using the chart choose the closest flow rate from the appropriate media grade column.

#### Equation:

Flow

Actual System Flow Rate (m3/hr)

×

Pressure

$$\frac{(7 \text{ (barg)} + 1 \text{ (barg)})}{(\text{System Pressure (barg)} + 1 \text{ (barg)})}$$

×

Temperature

$$\frac{(\text{System Temp (°C)} + 238 \text{ (°C)})}{(20 \text{ (°C)} + 238 \text{ (°C)})}$$

×

Specific Gravity

$$\sqrt{\text{Specific gravity}}$$

=

Adjusted Flow Rate

Adjusted Flow Rate (At 7 barg and 20°C)

#### Example:

For grade 6C filter, with an actual flow rate of 3000m3/hr of air, an actual pressure of 10 barg and temperature of 20°C. The equation would go as follows

3000 (m3/hr)

×

$$\frac{(7 \text{ (barg)} + 1 \text{ (barg)})}{(10 \text{ (barg)} + 1 \text{ (barg)})}$$

×

$$\frac{(20 \text{ (°C)} + 238 \text{ (°C)})}{(20 \text{ (°C)} + 238 \text{ (°C)})}$$

×

Note: Take the square route of your specific gravity. If this is for a compressed air application, skip this step as the specific gravity of air is one. Please consult Parker if you do not know your specific gravity.

=

Now go to the chart above, look down the media grade 6C column for a flow of 2400 m3/hr, you will see the correct housing is the **ZT19-016-6C**.

3000

×

0.8

×

1

×

1

=

2400 m3/hr

# Drying Compressed Air with Parker Membrane Technology

## Features

**Membrane Dryers offer atmospheric dew points to  $-40^{\circ}\text{C}$  for point-of-use critical applications**

**The 5000 Series Membrane Air Dryers offer plant-wide pressure dew points to  $2^{\circ}\text{C}$  for compressed air systems**

**Unattended 24-hour operation and quick easy maintenance**

**Explosion-proof and require no electricity**

**Silent operation**

**Lightweight and compact**

**Environmentally friendly with no refrigerants or freons**

## Applications

Instrument air for calibration of sensitive equipment  
HVAC systems  
Pneumatic equipment  
Instrument cabinets  
Electronic equipment blow-off air  
CNC/CMM machinery  
Prevention of freeze-ups  
Fire and sprinkler systems  
Pressurizing electrical cabinets  
Pneumatic controls  
Provide clean air for laser operation  
Dry air for hazardous areas  
General plant compressed air  
Chemical blanketing and packaging  
Process controls  
Electronics/Dry boxes  
Laser optics

## Balston Membrane Air Dryers

Utilise innovative membrane technology to provide clean, dry, compressed air at atmospheric dew points to  $-40^{\circ}\text{C}$ . This high efficiency, durable technology is quickly becoming the standard for drying compressed air. Balston Membrane Air Dryers require no electricity and contain no refrigerants or freons, making them environmentally sound. Balston membrane air dryers protect critical applications from the problems caused by moisture.



## Phase I – Pre-Filtration

Prior to entering the membrane drying module, the compressed air passes through a high efficiency coalescing filter to remove oil and water droplets and particulate contamination with an efficiency of 99.99% at 0.01 micron. The liquids removed continuously drip from the filter cartridge into the bottom of the housing, where they are automatically emptied by an autodrain assembly. The air leaving the prefilter, therefore, is laden only with water vapour, which will be removed by the membrane module.

## Phase II – Membrane Drying

The water vapour in the compressed air is removed by the principle of selective permeation through a membrane. The membrane module consists of bundles of hollow membrane fibres, each permeable only to water vapour. As the compressed air passes through the centre of these fibres, water vapour permeates through the walls of the fibre and dry air exits from the other end of the fibre. A small portion of the dry air (regeneration flow) is directed along the outside of the membrane fibre to carry away the surrounding moisture-laden air. The remainder of the dry air is piped to the application.

# Parker 5000 Series SMART Dryer System Membrane Air Dryers

## Features

- State-of-the-art membrane technology**
- 2°C pressure dew point - 13% dryer than typical refrigerant dryers**
- Durable - will hold up to the dirtiest compressed air system**
- No requirement for costly maintenance contracts**
- Output capacities to 1,020m<sup>3</sup>/h (600 scfm)**

## Applications

General Compressed Air Mainlines  
Process Controls  
HVAC Systems  
Instrument Cabinets  
CNC/CMM Machinery  
Fire and Sprinkler Systems  
Pneumatic Controls  
Chemical Blanketing and Packaging  
Electronics/Dry Boxes  
Laser Optics

## Benefits

Easy to install and quick to maintain  
No refrigerants or freons - environmentally friendly  
Similar configuration of inlet/outlet ports to that of refrigerant dryers for easy replacement installation

## State-of-the-Art Membrane Technology

Water vapour from the compressed air supply passes through the hollow fibres of the membrane. At the same time, a small portion of the dry air product is redirected along the length of the fibres to sweep out the water vapour which has permeated the membrane. The moisture-laden sweep gas is then vented to the atmosphere and clean, dry air is supplied to the compressed air distribution system. The SMART Dryer utilises sophisticated technology to monitor the air consumption and automatically adjusts the regenerative sweep flow as required. The variable sweep system results in significant energy savings and low operating



costs. The SMART Dryer technology offers an advantage over refrigerant air drying technology as it does not produce condensate. An average 170 m<sup>3</sup>/h (100 CFM) compressor system can produce up to 6,814 litres (1,500 gallons) of oily condensate per year. The refrigerant dryer condenses it into an oily/water emulsion which has to be disposed of, at a high cost to you. The Membrane Air Dryer is designed to operate continuously, 24 hours a day, 7 days a week. The only maintenance required is changing the prefilter cartridges twice a year, which takes approximately 5 minutes and requires no tools.

## Why buy a SMART Dryer instead of a cycling refrigerant air dryer?

The Smart Dryer can save you money and offer better performance. Refrigerant and desiccant air dryers, sized to meet worst-case operating conditions are often designed to run continuously regardless of the system's demands, when in fact the actual system conditions and demands are far less. The result is significant operating costs in wasted energy and wear and tear on refrigerant compressors, cooling systems, drains and other componentry. The SMART Dryer does not require refrigerant, compressors, cooling systems or other componentry that carries high operating costs (energy) and maintenance costs. The SMART Dryer utilises sophisticated technology to monitor the air consumption and automatically adjusts the regenerative sweep flow as required. The variable sweep system results in significant energy savings and low operating costs with no fluctuation in output dew points.

Additionally, there are no freons that need recharging, no compressors to be serviced and no cooling coils to be cored and cleaned. Most importantly, the SMART Dryer is producing a constant 2°C pressure dew point which is typically 13% dryer than a refrigerant air dryer (ppm weight in air).

The Parker Compressed Air System Dryer provides clean, dry compressed air from an existing compressed air supply through the use of state-of-the-art membrane technology. The dryers are capable of delivering dry air with a dew point of 2 °C at 7 Barg. No electrical supply is required to use the Parker Membrane Air Dryers. Each membrane air dryer is equipped with high efficiency coalescing prefilters to remove oil, water, and particulate contamination.

## Principal Specifications

Model Number	SMRT5100	SMRT5200	SMRT5300	SMRT5400	SMRT5500	SMRT5600
<b>Max Flow Rate @2°C dew point</b>	170 m³/h (100 SCFM)	340 m³/h (200 SCFM )	510 m³/h (300 SCFM)	680 m³/h (400 SCFM)	850 m³/h (500 SCFM)	1,020 m³/h (600 SCFM)
<b>Dew point <sup>(1)</sup></b>	2°C	2°C	2°C	2°C	2°C	2°C
<b>Min/Max Inlet Air Temp.</b>	4°C/49°C	4°C/49°C	4°C/49°C	4°C/49°C	4°C/49°C	4°C/49°C
<b>Ambient Temperature Range</b>	4°/43°C	4°/43°C	4°/43°C	4°/43°C	4°/43°C	4°/43°C
<b>Min/Max Inlet Pressure</b>	4.1/10 barg	4.1/10barg	4.1/10barg	4.1/10barg	4.1/10barg	4.1/10barg
<b>Max Compressed Air Requirement</b>	191 m³/h (113 SCFM)	384 m³/h (226 SCFM)	576 m³/h (339 SCFM)	768 m³/h (452 SCFM)	960 m³/h (565 SCFM)	1,152 m³/h (678 SCFM)
<b>Max Pressure Drop</b>	0.7 barg	0.7 barg	0.7 barg	0.7 barg	0.7 barg	0.7 barg
<b>Inlet/Outlet Port Size</b>	1½"NPT(Male)	2"NPT(Male)	2"NPT(Male)	2"NPT(Male)	2½"NPT(Male)	3"NPT(Male)
<b>Electrical Requirements</b>	None	None	None	None	None	None
<b>Dimensions</b>	320x1120x 400mm	320x1120x 400mm	320x1120x 680mm	320x1120x 680mm	320x1120x 950mm	320x1120x 950mm
<b>Shipping Weight</b>	80 kg	102 kg	136 kg	170 kg	215 kg	250 kg

## Ordering Information

Model Number	SMRT5100	SMRT5200	SMRT5300	SMRT5400	SMRT5500	SMRT5600
<b>Coalescing Prefilter Assembly</b>	2312N-1B1-DX 2312N-1B1-BX	ZT14-016-10C ZT14-016-6C	ZT14-016-10C ZT14-016-6C	ZT14-016-10C ZT14-016-6C	ZT17-016-10C ZT17-016-6C	ZT17-016-10C ZT17-016-6C
<b>Replacement Prefilter Cartridges</b>	200-35-DXE 200-35-BXE	10CZ27-200 6CZ27-200	10CZ27-200 6CZ27-200	10CZ27-200 6CZ27-200	10CZ27-298 6CZ27-298	10CZ27-298 6CZ27-298

### Notes:

- 1 Dew point specified for saturated inlet air at 38°C and 7 barg. Outlet flow and dew point will vary for other inlet conditions. Aftercooler and condensate separator may be required to reduce air temperature upstream of dryer.

# IT Series Membrane Air Dryers

**Offer a reliable, efficient and economical alternative to pressure swing and refrigerant dryer technologies**

**Require no electricity thus lowering operating costs**

**Produce +2°C pressure dew point, ideal for critical points of use**

**No moving parts**

**Silent operation**

**No desiccant to change**

## Applications

Food processing and automation  
Electronics/Dry Boxes  
Co-ordinate Measurement Machines  
Critical Pneumatic Valves  
Protection of Pneumatic Instrumentation  
Low dew point Instrument Air  
Pneumatic Equipment  
Pressurizing Electronic Cabinets  
Dry Air for Hazardous Areas



## Easy to Operate and Maintain

Installation consists of simply connecting a standard compressed air line to the inlet and connecting the outlet to your application. The unit is ready for trouble-free operation. This system is designed to operate 24 hours per day, 7 days per week.

Once the system is operating, it requires little monitoring. The only maintenance involves changing the coalescing prefilter cartridges periodically. The membrane module does not require any maintenance.

## Why Choose a Balston +2°C Membrane Dryer?

There are many variables that will affect the output specification of compressed air. By the time air reaches its intended point of use, changes in pressure, temperature and dew point can all contribute to potential contamination. As capital equipment tolerances become tighter and more sensitive to this contamination, maintenance costs will escalate if equipment is not adequately protected. In cases where standard air filtration is not sufficient or where the reliability, performance and operating cost of older dryer technologies is becoming more significant, a Balston Membrane Dryer provides a reliable and economical alternative.

## IT Series Point of Use Membrane Dryers

Balston Membrane Air Dryers combine superior coalescing filtration technology with a proven, innovative membrane system to supply clean, dry, +2°C dew point compressed air. The Balston Membrane Dryers are available in 6 different models which can deliver compressed air at flow rates up to 85 m<sup>3</sup>/hr with a +2°C dew point. The systems are engineered for easy installation, operation and long term reliability. By incorporating high efficiency coalescing filtration and the highest efficiency membrane available, the systems provide low cost operation with the lowest minimal maintenance.

## Principal Specifications

Type	IT0010-35	IT0030-35	IT0080-35	IT0150-35	IT0250-3560	IT0250-3500	IT0500-3560	IT0500-3500
<b>Inlet Port Size (NPT)</b>	1/4"	1/4"	1/4"	1/2"	1/2"	1/2"	1/2"	1/2"
<b>Outlet Port Size (NPT)</b>	1/4"	1/4"	1/4"	1/2"	1"	1"	1"	1"
<b>Min/Max Inlet Air Temp.</b>	4°C/49°C	4°C/49°C	4°C/49°C	4°C/49°C	4°C/49°C	4°C/49°C	4°C/49°C	4°C/49°C
<b>Ambient Temp. Range</b>	4°C/49°C	4°C/49°C	4°C/49°C	4°C/49°C	4°C/49°C	4°C/49°C	4°C/49°C	4°C/49°C
<b>Min/Max Inlet pressure</b>	4.1/10barg	4.1/10barg	4.1/10barg	4.1/10barg	4.1/6.9barg	6.9/10barg	4.1/6.9barg	6.9/10barg
<b>Compressed Air Requirement</b>	Total Air consumption = Regeneration Flow + Outlet Flow							
<b>Max. Pressure Drop</b>	0.2bar	0.2bar	0.2bar	0.2bar	0.34bar	0.334bar	0.34bar	0.34bar
<b>Wall Mountable</b>	Yes	Yes	Yes	Yes	Yes	Yes	Yes	Yes
<b>Mechanical Separator Included</b>	F14F17B	F06F18B	F06F18B	F07F38B	F07F38B	F07F38B	F07F38B	F07F38B
<b>Coalescing Prefilters (1)</b>	8A02N-0B2-BX 1	2002N-0B1-BX 1	2002N-0B1-BX 1	B2004N-1B1-DX B2004N-0B1-BX	2104N-1B1-DX 2104NN-0B1-BX	2104N-1B1-DX 2104N-0B1-BX	2208N-1B1-DX 2208N-0B1-BX	2208N-1B1-DX 2208N-0B1-BX
<b>Electrical Requirements</b>	None	None	None	None	None	None	None	None
<b>Dimensions (cm) (LxWxD)</b>	44.5x20.3x6.3	45.2x10.5x6.3	61x28.2x6.3	63.5x40.6x11.4	66x45.7x15.2	66x45.7x15.2	99x53.3x15.2	99x53.3x15.2
<b>Shipping Weight (kg)</b>	0.73	3	3	6.75	11.11	11.1	16.55	16.55

### Notes:

1 If compressed air is extremely contaminated a grade DX prefilter should be installed directly upstream from the membrane dryer.

## Flow Rates at 2°C Pressure dew point (1)

Model Number	IT0010-35	IT0030-35	IT0080-35	IT0150-35	IT0250-3560	IT0250-3500	IT0500-3560	IT0500-3500
<b>Flow @ 7 barg inlet pressure (m3/hr)</b>	1.7	5.1	13.6	25.5	42.5	N/A	85	N/A
<b>Flow @ 7.1/10 barg inlet pressure (m3/hr)</b>	1.7	5.1	13.6	25.5	N/A	42.5	N/A	85
<b>Regeneration Flow @ 7 barg (m3/hr)</b>	0.4	0.9	2.5	4.6	7.6	7.6	15.2	15.2

(1) Dew point specified for saturated inlet air at 38° and 7 barg.

## Ordering Information for technical assistance please call +44 (0)1622 723300

Model Number	IT0010-35	IT0030-35	IT0080-35	IT0150-35	IT0250-3560	IT0250-3500	IT0500-3560	IT0500-3500
<b>Replacement Prefilter Cartridges</b>								
<b>Stage 1</b>	PS403	PS702	PS702	PS802	PS802	PS802	PS802	PS802
<b>Stage 2</b>	-	-	-	5/100-12-DXE	5/100-18-DXE	5/100-18-DXE	5/100-19-DXE	5/150-19-DXE
<b>Stage 3</b>	5/050-05-BXE	5/100-12-BXE	5/100-12-BXE	5/100-12-BXE	5/100-18-BXE	5/100-18-BXE	5/150-19-BXE	5/150-05-BXE



**Parker Hannifin**

Hermitage Court, Hermitage Lane, Maidstone, Kent ME16 9NT, England

Phone: +44 (0)1622 723 300 Fax: +44 (0)1622 728 703 E-mail: [pagsservicesupport@parker.com](mailto:pagsservicesupport@parker.com) Web site: [www.parker.com/pag](http://www.parker.com/pag)

# Point-of-Use Membrane Dryers

## Dry Air for Critical Applications

### Features

- Provide clean, dry compressed air**
- Offer a reliable, efficient and economical alternative to pressure swing and refrigerant dryer technologies**
- Require no electricity low operating costs**
- Built-in high-efficiency prefilter**
- Atmospheric dew points as low as -40°C prevent freezing**
- Inherently safe in hazardous areas**
- Silent operation**
- No refrigerants or freons**
- No desiccant to change**
- No moving parts or motors**

The Parker Compressed Air Point of Use Dryer are capable of delivering clean, dry compressed air with a dew point of -40 °C at atmospheric pressure. No electrical supply is required to use the Parker Membrane Air Dryer. Each membrane air dryer is equipped with a high efficiency coalescing prefilter to remove oil, water, and particulate contamination.

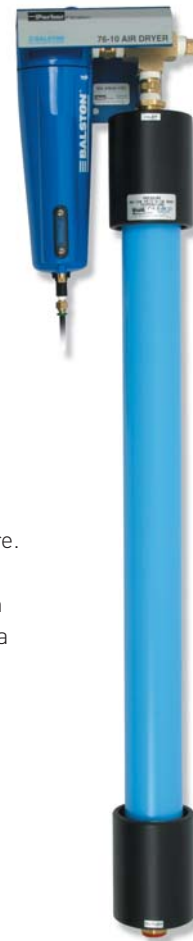

### Applications

- Low dew point instrument air
- Pneumatic equipment
- Pressurising electronic cabinets and cables
- Analytical instrumentation
- Prevention of freezing
- Dry air for hazardous areas
- General critical air supply
- Flexibility of required dew point
- Process controls
- Instrument cabinets
- CNC/CMM machinery
- Electronics and telecommunications
- Robotics
- Laser technology
- Optical instrumentation

### State-of-the-Art Membrane Technology

Water vapour from the compressed air supply passes through the hollow fibres of the membrane. At the same time, a small portion of the dry air product is redirected along the length of the fibres to sweep out the water vapour-laden air which has permeated the membrane. The moisture-laden sweep gas is then vented to the atmosphere and clean, dry air is supplied to the application. This technology offers another advantage over refrigerant air drying technology as it does not produce condensate. The refrigerant dryer condenses it into an oily/water emulsion which has to be disposed of at high cost to you! The Balston Membrane Air Dryer is designed to operate continuously, 24 hours per day, 7 days per week. The only maintenance required is changing the prefilter twice a year. This annual maintenance takes approximately 5 minutes.

## Principal Specifications

Type	76-01	76-02	76-10	76-20	76-40	76-100-4050
Port Size Inlet/Outlet	1/4" NPT (F)	1/4" NPT (F)	1/2" NPT (F)	1" NPT (F)	1 1/2" NPT (F) 3/4" NPT (F)	2" NPT (M)
Min/Max Inlet Air Temp. <sup>(4)</sup>	4°C/49°C	4°C/49°C	4°C/49°C	4°C/49°C	4°C/49°C	4°C/49°C
Ambient Temp. Range	4°C - 49°C	4°C - 49°C	4°C - 49°C	4°C - 49°C	4°C - 49°C	4°C - 49°C
Min/Max Inlet Pressure	4.1/10 barg	4.1/10 barg	4.1/10 barg	4.1/10 barg	4.1/10 barg	4.1/10 barg
Compressed Air Requirement	Total Air Consumption: Regeneration Flow + Outlet Flow					
Max. Pressure Drop <sup>(1)</sup>	0.34 barg	0.34 barg	0.34 barg	0.34 barg	0.34 barg	0.34 barg
Wall Mountable	Yes	Yes	Yes	Yes	Yes	No
Electrical Requirements	None	None	None	None	None	None
Dimensions	150x580x130mm	150x580x130mm	150x940x130mm	300x940x180mm	480x990x210mm	1290x1670x710mm
Shipping Weight	4kg	5kg	9kg	9kg	16kg	341kg

### Notes:

- 0.34 barg at -40°C dew point operating parameters.
- If compressed air is extremely contaminated, a Balston Grade DX prefilter should be installed directly upstream from the membrane dryer.
- Dew points indicated are for maximum inlet/ambient temperature of 38°C.
- Maximum inlet air pressure dew point is 38°C. Inlet dew point must not exceed this figure.

## Flow Rates

Type	Outlet flow m³/h (SCFM) at indicated operating pressure for -40°C atmospheric dew point				
	4 barg	5.5 barg	7 barg	8.3 barg	9.6 barg
76-01	0.5 [0.3]	1.0 [0.6]	1.7 [1.0]	2.2 [1.3]	2.9 [1.7]
76-02	1.2 [0.7]	1.7 [1.0]	3.4 [2.0]	4.4 [2.6]	5.8 [3.4]
76-10	5.6 [3.3]	8.5 [5.0]	17.0 [10.0]	22.1 [13.0]	28.9 [17.0]
76-20	11.2 [6.6]	17.0 [10.0]	34.0 [20.0]	44.2 [26.0]	57.8 [34.0]
76-40	22.4 [13.2]	34.0 [20.0]	68.0 [40.0]	88.3 [52]	115.5 [68.0]
76-100-4050	56.0 [33.0]	85.0 [50.0]	170.0 [100.0]	220.9 [130.0]	292 [170.0]

## Membrane Module Regeneration Flow

Type	Regeneration flow m³/h (SCFM) at indicated operating pressure and all dew points				
	4 barg	5.5 barg	7 barg	8.3 barg	9.6 barg
76-01	0.3 [0.2]	0.3 [0.2]	0.5 [0.3]	0.5 [0.3]	0.5 [0.3]
76-02	0.5 [0.3]	0.7 [0.4]	0.8 [0.5]	1.0 [0.6]	1.2 [0.7]
76-10	2.9 [1.7]	3.6 [2.1]	4.2 [2.5]	5.1 [3.0]	5.9 [3.5]
76-20	5.8 [3.4]	7.1 [4.2]	8.5 [5.0]	10.2 [6.0]	11.9 [7.0]
76-40	11.6 [6.8]	14.3 [8.4]	17.0 [10.0]	20.4 [12.0]	23.8 [14.0]
76-100-4050	28.9 [17.0]	35.7 [21.0]	42.5 [25.0]	51.0 [30.0]	59.5 [35.0]

## Ordering Information

Balston Membrane Air Dryer	76-01	76-02	76-10	UK76-20	UK76-40	UK76-100-4050
Replacement Prefilter Cartridges	100-12-BX	100-12-BX	100-18-BX	150-19-BX	200-35-BX	200-80-DX
Optional Additional Coalescing Prefilter	2002G-1B1-DX	2002G-1B1-DX	2104G-1B1-DX	2208G-1B1-DX	2312G-1B1-DX	ZT14-016-6C
Replacement Filter Cartridges for Optional Prefilter	100-12-DX	100-12-DX	100-18-DX	150-19-DX	200-35-DX	10CZ27-200



Parker Hannifin

Hermitage Court, Hermitage Lane, Maidstone, Kent ME16 9NT, England

Phone: +44 (0)1622 723 300 Fax: +44 (0)1622 728 703 E-mail: [pagsservicesupport@parker.com](mailto:pagsservicesupport@parker.com) Web site: [www.parker.com/pag](http://www.parker.com/pag)

# Desiccant Dryer

## Economical In-line Drying

### Features

- Steel bowl with integral sight glass
- Lightweight zinc head
- Sintered bronze elements
- prevent desiccant carry-over
- Maximum operating temperature 82°C
- Maximum working pressure 20 barg
- Optimum working temperature <38°C

### FDD Series Desiccant Dryer

Parker's unique in-line air/gas dryer system is engineered for easy desiccant changeouts, longer life and lower pressure drop.

The FDD Series is designed to remove water vapour and aerosols at point-of-use for intermittent flow up to 25 m³/h. Finite dryers do not require steady flow for constant dew point suppression.

A colour changing moisture indicator with visual sight indicates the desiccant needs replacement.

RESULT: Zero loss of expensive compressed air, which results in lower overall operating cost.

### Principal Specifications

Model No. Housing Only** (NPT)	Port Size	Flow Capacity (m³/h)	Flow Capacity (SCFM)	Desiccant Capacity (Kg)
FDD15-02*	1/4"	25	15	1.1
FDD15-03*	3/8"	25	15	1.1
FDD15-04*	1/2"	25	15	1.1
FDD15-06	3/4"	25	15	1.1
Desiccant Type		2.3 kg (5lb) Can	Master pack 4 x 2.3 kg (5lb) Can	
Silica gel (all indicating)		FSGM100-1	FSGM100-4	
Molecular Sieve		FMS100-1	FMS100-4	
(non-indicating)				

\*These dryers supplied with reducer bushings.  
\*\*Desiccant sold separately

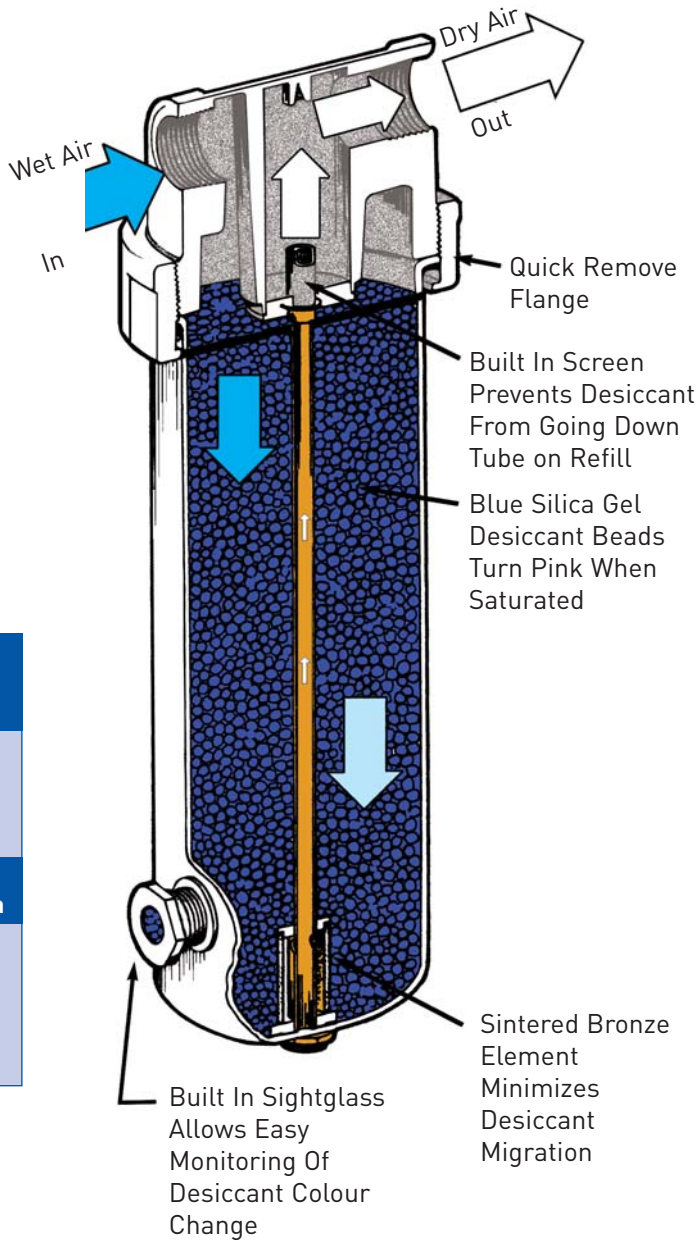

# Zero Air Loss Drain

## Conserving Costly Compressed Air

### Features

Electronic condensate drains of the Zero Air series feature:- Non-wearing magnetic-core level control for optimised and loss free discharge of condensate

Integrated dirt screen between level measurement and drain valve to protect the diaphragm valve with alarm monitoring

Diaphragm valve with large cross-section and condensate pilot control for extended service life

Potential-free alarm contact ZLD013



### Non-wearing magnetic-core level control

The magnetic-core level control employs fixed switching points to operate the valve. The magnetic core signal transmitter position is detected by non-contact magnetic sensors:

- independent of the condensate type (water/oil)
- independent of the working pressure

The collecting vessel integrated in the condensate drain is always used at optimum efficiency. This results in a minimised number of switching cycles and thus, in a maximum service life of the drain valve. No calibration required!

### Integrated dirt screen

The dirt screen which is integrated between the level control and the drain valve:

- retains any contaminants that could damage the diaphragm valve
- triggers an alarm, also if the screen is clogged by dirt
- allows the drain to be cleaned easily and rapidly

Therefore, it considerably increases the operating safety of the condensate drain. Since the condensate is pressed through the screen at working pressure, it will normally not need to be cleaned between the maintenance intervals.

ZLD006

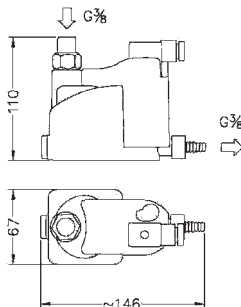

ZLD013

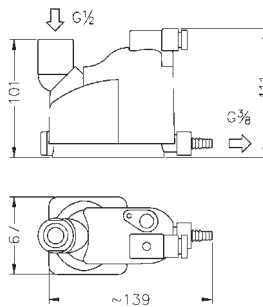

ZLD023

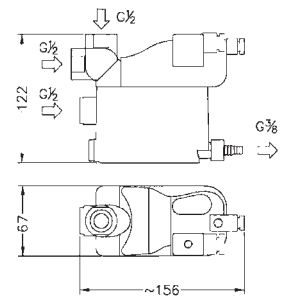

### Principal Specifications

Model	Compressor aftercooler	Capacity *1 Refrigeration dryer	Filter *2	Max Working pressure	Temperature range	Connections
ZLD006	-	-	720 m³/h	16 bar	1 - 60°C	G 3/8
ZLD013	240 m³/h	480 m³/h	2,400 m³/h	16 bar	1 - 60°C	1 x G 1/2, G 1/8
ZLD023	420 m³/h	840 m³/h	4,200 m³/h	16 bar	1 - 60°C	2 x G 1/2, G 1/8

\*1 referred to 1 bar(a) and 20°C at 7 bar working pressure, suction air compressor 25°C at 60% RH, air discharge temperature aftercooler 35°C, pressure dew point refrigeration dryer 3°C

\*2 Condensate from aftercooler or refrigeration dryer to be drained upstream - only for residual oil content or small quantities of condensate  
Standard version with BSP thread (G) for 230V/50 - 60Hz supply voltage (230).  
Alternatively, versions with NPT thread (N) or 115V/50 - 60Hz (115) or 24V/50 - 60Hz (024) are available.  
24V DC on request



Parker Hannifin

Hermitage Court, Hermitage Lane, Maidstone, Kent ME16 9NT, England

Phone: +44 (0)1622 723 300 Fax: +44 (0)1622 728 703 E-mail: [pagsservicesupport@parker.com](mailto:pagsservicesupport@parker.com) Web site: [www.parker.com/pag](http://www.parker.com/pag)

# Parker Nitrogen Generation Membrane Technology

---

**Simplicity and elegance describes the working principle of Parker's hollow fibre membrane technology.**

**Nitrogen is produced from hollow fibres which have selective diffusion rates. As compressed air is passed through the membrane modules consisting of thousands of hollow fibres, nitrogen is separated. Compressed air consists mainly of nitrogen, oxygen and other trace gases such as helium, together with water vapour. Water vapour, helium and oxygen diffuse quickly through the membrane wall, leaving nitrogen as the product.**

## NitroFlow®

Parker nitrogen generators are based on Parker hollow fibre membrane technology, which makes it possible to separate air into nitrogen and an oxygen-enriched stream.

NitroFlow® is available in both low pressure (LP) and high pressure (HP) ranges. Using NitroFlow® LP when no pressure is needed and opting for NitroFlow® HP when the application requires high pressure or when nitrogen storage is needed.

The NitroFlow® LP range has built-in compressors to produce nitrogen from ambient air simply by connecting to a mains voltage power source. A unique process and system design eliminates the need for condensed water removal and draining, ensuring the longest compressor and membrane life.

The NitroFlow® HP range requires compressed air either from a central system, or from a dedicated compressor. An optional additional storage vessel enables variable or peak consumption to be handled.

NitroFlow® will automatically switch on and off, depending on the nitrogen demand. With low running costs, NitroFlow® offers an unlimited, virtually maintenance-free and reliable source of nitrogen.

## TyreSaver®

Specially designed for filling motorcycle, car and truck tyres.

Filling tyres with nitrogen can bring benefits of longer tyre life, better fuel consumption and increased safety.

## NitroSource®

A modular design, which accommodates increased requirements through easy expansion.

Digital data management means intuitive commands with advanced features such as data logging and remote control.





## Applications

All living things require oxygen but oxygen also speeds up degradation and oxidation of valuable products. Gas and dust mixtures are explosive when sufficient oxygen is present. Low oxygen environments prevent degradation and the risk of explosion. Reducing the oxygen concentration can be achieved by adding nitrogen, resulting in enhanced quality and safety. Because of this, nitrogen is the most widely used gas in the industry.

### Oil and Gas

In the Oil and Gas industry, inert gas systems are used to generate oxygen depleted air, which is required for many processes such as gas-seal compression, purging of tubing, blanketing storage tanks or purging flare systems.

### Food

Oxygen is the biggest enemy of food products. Oxygen reduced packaging, storage and transport increases the product shelf life benefiting both the producer and the consumer.



### Blanketing

To prevent degradation of products or risk of explosion, storage facilities can be blanketed with nitrogen. Examples include the blanketing of chemicals, water, food or petrochemical products.

### Oxygen enrichment

Parker membrane technology separates nitrogen from air, leaving an oxygen-enriched by product which is normally discarded. However, the oxygen-enriched air can be used for other applications. For some years oxygen enriched air has been used for nitrox diving instead of normal air.

# Par-Fit

## Parker Quality Elements for other Manufacturers' Housings

High filtration efficiency, low operating costs, long life, high quality and the convenience of purchasing your products from a single supplier are the **Parker** advantages.

You can have all of the benefits inherent in a **Parker** filter element without the need to replace your existing filter housing.

### Domnick Hunter

NOTE: Do not use '3P' element on liquid applications. '3P' grade is 3 micron absolute and has 20 times the surface area of the original element.

Part Number	Parker Part Number
-------------	--------------------

#### High Efficiency Coalescing Filters

A03/1	6CJ10-030 x 1
A03/1.5	6CJ13-030 x 1
A04/1.5	6CJ13-044 x 1
A04/2.5	6IJ15-040 x 1
A05/2.5	6IJN15-050 x 1
A05/3	6IJ25-050 x 1
A010/3	6IJ25-100 x 1
A015/3	6IG25-150 x 1
A020/3	6IG25-200 x 1
A030/3	6IG25-300 x 1
A030/5	6QG43-300 x 1
AA3/1	6CJ10-030 x 1
AA3/1.5	6CJ13-030 x 1
AA4/1.5	6CJ13-044 x 1
AA4/2.5	6IJ15-040 x 1
AA5/2.5	6IJN15-050 x 1
AA5/3	6IJ25-050 x 1
AA10/3	6IJ25-100 x 1
AA15/3	6IG25-150 x 1
AA20/3	6IG25-200 x 1
AA30/3	6IG25-300 x 1
AA30/5	6QG43-300 x 1
A002/05	6HJN08-024 x 1
A003/05	6HJN08-030 x 1
A003/10	6CJN10-030 x 1
A004/10	6CJN10-040 x 1
A004/20	6CJN13-040 x 1
A005/20	6CJN13-050 x 1
A005/25	6IJN15-050 x 1
A007/25	6IJN15-070 x 1
A007/30	6IJN25-070 x 1
A010/30	6IJN25-100 x 1
A015/30	6IGN25-150 x 1
A020/30	6IGN25-200 x 1
A030/30	6IGN25-300 x 1
A030/50	6QGN43-300 x 1
AA02/05	4HJN08-024 x 1
AA03/05	4HJN08-030 x 1
AA03/10	4CJN10-030 x 1
AA04/10	4CJN10-040 x 1
AA04/20	4CJN13-040 x 1
AA05/20	4CJN13-050 x 1
AA05/25	4IJN15-050 x 1
AA07/25	4IJN15-070 x 1
AA07/30	4IJN25-070 x 1
AA10/30	4IJN25-100 x 1
AA15/30	4IGN25-150 x 1
AA20/30	4IGN25-200 x 1
AA30/30	4IGN25-300 x 1
AA30/50	4QGN43-300 x 1
E006AA	6CF08-026 x 1

### Domnick Hunter

Part Number	Parker Part Number
-------------	--------------------

E013AA	6IF10-032 x 1
E025AA	6IF10-046 x 1
E040AA	6IF20-063 x 1
E085AA	6IF20-102 x 1
E195AA	6IF25-134 x 1
E295AA	6IF25-254 x 1
E400AA	6CF35-165 x 1
E500AA	6CF43-252 x 1
E620AA	6CF35-251 x 1
EP1001AO	6QP19-098 x 2
EZ1030AA	6CZ07-020 x 1
EZ1050AA	6CZ12-023 x 1
EZ1070AA	6CZ12-029 x 1
EZ1140AA	6CZ12-056 x 1
EZ2010AA	6CZ20-046 x 1
EZ2020AA	6CZ20-086 x 1
EZ2030AA	6CZ20-126 x 1
EZ2050AA	6CZ20-200 x 1
EZ3050AA	6CZ27-200 x 1
EZ3075AA	6CZ27-298 x 1
EZ5060AA	6CZ46-239 x 1
EZ5075AA	6CZ50-298 x 1
K145AA	6IF20-102 x 1
K220AA	6IF25-134 x 1
K330AA	6IF25-254 x 1
K430AA	6IF35-165 x 1

#### General Purpose Filters

E006AO	10CF08-026 x 1
E013AO	10IF10-032 x 1
E025AO	10IF10-046 x 1
E040AO	10IF20-063 x 1
E085AO	10IF20-102 x 1
E195AO	10IF25-134 x 1
E295AO	10IF25-254 x 1
E400AO	10CF35-165 x 1
E500AO	10CF43-252 x 1
E620AO	10CF35-251 x 1
EZ1030AO	10CZ07-020 x 1
EZ1050AO	10CZ12-023 x 1
EZ1070AO	10CZ12-029 x 1
EZ1140AO	10CZ12-056 x 1
EZ2010AO	10CZ20-046 x 1
EZ2020AO	10CZ20-086 x 1
EZ2030AO	10CZ20-126 x 1
EZ2050AO	10CZ20-200 x 1
EZ3050AO	10CZ27-200 x 1
EZ3075AO	10CZ27-298 x 1
EZ5060AO	10CZ46-239 x 1
EZ5075AO	10CZ50-298 x 1
K145AO	10IF20-102 x 1
K220AO	10IF25-134 x 1
K330AO	10IF25-254 x 1
K430AO	10CF35-165 x 1

### Domnick Hunter

Part Number	Parker Part Number
-------------	--------------------

#### Particulate Filters

EP1001PL	3PP19-098 x 2
PF 02/05	12GJN08-024 x 1
PF 03/05	12GJN08-030 x 1
PF 03/10	3PJN10-030 x 1
PF 04/10	3PJN10-040 x 1
PF 04/20	3PJN13-040 x 1
PF 05/20	3PJN13-050 x 1
PF 05/25	3PJN15-050 x 1
PF 07/25	3PJN15-070 x 1
PF 07/30	3PJN25-070 x 1
PF 10/30	3PJN25-100 x 1
PF 15/30	3PGN25-150 x 1
PF 20/30	3PGN25-200 x 1
PF 30/30	3PGN25-300 x 1
PF 30/50	3PGN43-300 x 1

#### Oil Vapour & Odour Removal

AC3/1	AJ10-030 x 1
AC3/1.5	AJ13-030 x 1
AC4/1.5	AJ13-044 x 1
AC4/2.5	AJ15-040 x 1
AC5/2.5	AJN15-050 x 1
AC5/3	AJ25-050 x 1
AC10/3	AJ25-100 x 1
AC15/3	AG25-150 x 1
AC20/3	AG25-200 x 1
AC30/3	AG25-300 x 1
AC30/5	AG43-300 x 1
AC 02/05	AJN08-024 x 1
AC 03/05	AJN08-030 x 1
AC 03/10	AJN10-030 x 1
AC 04/10	AJN10-040 x 1
AC 04/20	AJN13-040 x 1
AC 05/20	AJN13-050 x 1
AC 05/25	AJN15-050 x 1
AC 07/25	AJN15-070 x 1
AC 07/30	AJN25-070 x 1
AC 10/30	AJN25-100 x 1
AC 15/30	AGN25-150 x 1
AC 20/30	AGN25-200 x 1
AC 30/30	AGN25-300 x 1
AC 30/50	AGN43-300 x 1
E006AC	AF08-026 x 1
E013AC	AF10-032 x 1
E025AC	AF10-046 x 1
E040AC	AF20-063 x 1
E085AC	AF20-102 x 1
E195AC	AF25-134 x 1
E295AC	AF25-254 x 1
E400AC	AF35-165 x 1
E500AC	AF43-252 x 1
E620AC	AF35-251 x 1
EZ1030AC	AZ07-020 x 1
EZ1050AC	AZ12-023 x 1
EZ1070AC	AZ12-029 x 1
EZ1140AC	AZ12-056 x 1

# Par-Fit

## Parker Quality Elements for other Manufacturers' Housings

### Domnick Hunter

Part Number	Parker Part Number
-------------	--------------------

EZ2010AC	AZ20-046 x 1
EZ2020AC	AZ20-086 x 1
EZ2030AC	AZ20-126 x 1
EZ2050AC	AZ20-200 x 1
EZ3050AC	AZ27-200 x 1
EZ3075AC	AZ27-298 x 1
EZ5060AC	AZ46-239 x 1
EZ5075AC	AZ50-298 x 1
K145ACS	AF20-102 x 1
K220ACS	AF25-134 x 1
K330ACS	AF25-254 x 1
K430ACS	AF35-165 x 1

### Headline

Part Number	Parker Part Number
-------------	--------------------

12-16-70C	10H04-006 x 10
12-16-50C	6H04-006 x 10
12-16-70K	10S04-006 x 10
12-16-50C	6S04-006 x 10
12-32-70C	10H04-013 x 10
12-57-70C	10H04-023 x 10
25-64-70C	10H10-025 x 8
25-127-70C	10H10-050 x 4
25-178-70C	10H10-070 x 4
38-152-70C	10H15-060 x 4
51-89-70C	10H20-035 x 4
51-230-70C	10H20-090 x 2
51-476-70C	10H20-187 x 1
12-32-50C	6H04-013 x 10
12-57-50C	6H04-023 x 10
25-64-50C	6H10-025 x 8
25-127-50C	6H10-050 x 4
25-178-50C	6H10-070 x 4
38-152-50C	6H15-060 x 4
51-89-50C	6H20-035 x 4
51-230-50C	6H20-090 x 2
51-476-50C	6H20-187 x 1
12-32-70K	10T04-013 x 10
12-57-70K	10T04-023 x 10
25-64-70K	10T10-025 x 10
25-178-70K	10T10-070 x 10
38-152-70K	10T15-060 x 10
51-230-70K	10T20-090 x 10
51-476-70K	10T20-187 x 10
12-32-50K	6T04-013 x 10
12-57-50K	6T04-023 x 10
25-64-50K	6T10-025 x 10
25-178-50K	6T10-070 x 10
38-152-50K	6T15-060 x 10
51-230-50K	6T20-090 x 10
51-476-50K	6T20-187 x 10

### Ultrafilter

Part Number	Parker Part Number
-------------	--------------------

#### 80 Series Prefilters

V-PE 3/1	3PJ10-030 x 1
V-PE 3/1,5	3PJ13-030 x 1
V-PE 4/1,5	3PJ13-044 x 1

### Ultrafilter

Part Number	Parker Part Number
-------------	--------------------

V-PE 4/2,5	3PJ15-040 x 1
V-PE 5/2,5	3PJN15-050 x 1
V-PE 5/3	3PJ25-050 x 1
V-PE 10/3	3PJ25-100 x 1
V-PE 15/3	3PG25-150 x 1
V-PE 20/3	3PG25-200 x 1
V-PE 30/3	3PG25-300 x 1
V-PE 30/5	3PG43-300 x 1

#### Fine Filters

FF 3/1	10CJ10-030 x 1
FF 3/1,5	10CJ13-030 x 1
FF 4/1,5	10CJ13-044 x 1
FF 4/2,5	10IJ15-040 x 1
FF 5/2,5	10IJN15-050 x 1
FF 5/3	10IJ25-050 x 1
FF 10/3	10IJ25-100 x 1
FF 15/3	10IG25-150 x 1
FF 20/3	10IG25-200 x 1
FF 30/3	10IG25-300 x 1
FF 30/5	10QG43-300 x 1

#### Micro Filters

MF 3/1	6CJ10-030 x 1
MF 3/1,5	6CJ13-030 x 1
MF 4/1,5	6CJ13-044 x 1
MF 4/2,5	6IJ15-040 x 1
MF 5/2,5	6IJN15-050 x 1
MF 5/3	6IJ25-050 x 1
MF 10/3	6IJ25-100 x 1
MF 15/3	6IG25-150 x 1
MF 20/3	6IG25-200 x 1
MF 30/3	6IG25-300 x 1
MF 30/5	6QG43-300 x 1

#### Sub Micro Filters

SMF 3/1	4CJ10-030 x 1
SMF 3/1,5	4CJ13-030 x 1
SMF 4/1,5	4CJ13-044 x 1
SMF 4/2,5	4IJ15-040 x 1
SMF 5/2,5	4IJN15-050 x 1
SMF 5/3	4IJ25-050 x 1
SMF 10/3	4IJ25-100 x 1
SMF 15/3	4IG25-150 x 1
SMF 20/3	4IG25-200 x 1
SMF 30/3	4IG25-300 x 1
SMF 30/5	4QG43-300 x 1

#### Active Carbon Filters

AK 3/1	AJ10-030 x 1
AK 3/1,5	AJ13-030 x 1
AK 4/1,5	AJ13-044 x 1
AK 4/2,5	AJ15-040 x 1
AK 5/2,5	AJN15-050 x 1
AK 5/3	AJ25-050 x 1
AK 10/3	AJ25-100 x 1
AK 15/3	AG25-150 x 1
AK 20/3	AG25-200 x 1
AK 30/3	AG25-300 x 1
AK 30/5	AG43-300 x 1

#### 90 Series Prefilters

PE 02/05	12GJN08-024 x 1
PE 03/05	12GJN08-030 x 1
PE 03/10	3PJN10-030 x 1
PE 04/10	3PJN10-040 x 1
PE 04/20	3PJN13-040 x 1
PE 05/20	3PJN13-050 x 1

### Ultrafilter

Part Number	Parker Part Number
-------------	--------------------

PE 05/25	3PJN15-050 x 1
PE 07/25	3PJN15-070 x 1
PE 07/30	3PJN25-070 x 1
PE 10/30	3PJN25-100 x 1
PE 15/30	3PGN25-150 x 1
PE 20/30	3PGN25-200 x 1
PE 30/30	3PGN25-300 x 1
PE 30/50	3PGN43-300 x 1

#### Fine Filters

FF 02/05	10HJN08-024 x 1
FF 03/05	10HJN08-030 x 1
FF 03/10	10CJN10-030 x 1
FF 04/10	10CJN10-040 x 1
FF 04/20	10CJN13-040 x 1
FF 05/20	10CJN13-050 x 1
FF 05/25	10IJN15-050 x 1
FF 07/25	10IJN15-070 x 1
FF 07/30	10IJN25-070 x 1
FF 10/30	10IJN25-100 x 1
FF 15/30	10IGN25-150 x 1
FF 20/30	10IGN25-200 x 1
FF 30/30	10IGN25-300 x 1
FF 30/50	10QGN43-300 x 1

#### Micro Filters

MF 02/05	6HJN08-024 x 1
MF 03/05	6HJN08-030 x 1
MF 03/10	6CJN10-030 x 1
MF 04/10	6CJN10-040 x 1
MF 04/20	6CJN13-040 x 1
MF 05/20	6CJN13-050 x 1
MF 05/25	6IJN15-050 x 1
MF 07/25	6IJN15-070 x 1
MF 07/30	6IJN25-070 x 1
MF 10/30	6IJN25-100 x 1
MF 15/30	6IGN25-150 x 1
MF 20/30	6IGN25-200 x 1
MF 30/30	6IGN25-300 x 1
MF 30/50	6QGN43-300 x 1

#### Sub Micro Filters

SMF 02/05	4HJN08-024 x 1
SMF 03/05	4HJN08-030 x 1
SMF 03/10	4CJN10-030 x 1
SMF 04/10	4CJN10-040 x 1
SMF 04/20	4CJN13-040 x 1
SMF 05/20	4CJN13-050 x 1
SMF 05/25	4IJN15-050 x 1
SMF 07/25	4IJN15-070 x 1
SMF 07/30	4IJN25-070 x 1
SMF 10/30	4IJN25-100 x 1
SMF 15/30	4IGN25-150 x 1
SMF 20/30	4IGN25-200 x 1
SMF 30/30	4IGN25-300 x 1
SMF 30/50	4QGN43-300 x 1

#### Active Carbon Filters

AK 02/05	AJN08-024 x 1
AK 03/05	AJN08-030 x 1
AK 03/10	AJN10-030 x 1
AK 04/10	AJN10-040 x 1
AK 04/20	AJN13-040 x 1
AK 05/20	AJN13-050 x 1
AK 05/25	AJN15-050 x 1
AK 07/25	AJN15-070 x 1
AK 07/30	AJN25-070 x 1



Parker Hannifin

Hermitage Court, Hermitage Lane, Maidstone, Kent ME16 9NT, England

Phone: +44 (0)1622 723 300 Fax: +44 (0)1622 728 703 E-mail: [pagsservicesupport@parker.com](mailto:pagsservicesupport@parker.com) Web site: [www.parker.com/pag](http://www.parker.com/pag)

# Par-Fit

## Parker Quality Elements for other Manufacturers' Housings

### Ultrafilter

Part Number	Parker Part Number
-------------	--------------------

AK 10/30	AJN25-100 x 1
AK 15/30	AGN25-150 x 1
AK 20/30	AGN25-200 x 1
AK 30/30	AGN25-300 x 1
AK 30/50	AGN43-300 x 1

#### Process Gas Elements

P-PE 07/30	3PGN25-070 x 1
P-PE 10/30	3PGN25-100 x 1
P-MF 07/30	6IGN25-070 x 1
P-MF 10/30	6IGN25-100 x 1
P-SMF 07/30	4IGN25-070 x 1
P-SMF 10/30	4IGN25-100 x 1
P-FF 07/30	10IJN25-070 x 1
P-FF 10/30	10IJN25-100 x 1
P-AK 07/30	AGN25-070 x 1
P-AK 10/30	AGN25-100 x 1

### Zander

Part Number	Parker Part Number
-------------	--------------------

1030 *	*Z07-020 x 1
1050 *	*Z12-023 x 1
1070 *	*Z12-029 x 1
1140 *	*Z12-056 x 1
2010 *	*Z20-046 x 1
2020 *	*Z20-086 x 1
2030 *	*Z20-126 x 1
2050 *	*Z20-200 x 1
3050 *	*Z27-200 x 1
3075 *	*Z27-298 x 1
5060 *	*Z46-239 x 1
5075 *	*Z50-298 x 1

\*Zander Media Designation

A  
V  
X  
Y  
Z

Example:  
converts to

\*Parker Element Grade

A = Adsorber  
3P = Particulate  
6C = Grade 6 Coalescer  
8C = Grade 8 Coalescer  
10C = Grade 10 Coalescer

Zander 2030X  
Finite 6CZ20-126 x 1

### Flair

Part Number	Parker Part Number
-------------	--------------------

DH006AA	6CF08-026 x 1
DH006AC	AF08-026 x 1
DH006AO	10CF08-026 x 1
DH013AA	6IF10-032 x 1
DH013AC	AF10-032 x 1
DH013AO	10IF10-032 x 1
DH025AA	6IF10-046 x 1
DH025AC	AF10-046 x 1
DH025AO	10IF10-046 x 1
DH040AA	6IF20-063 x 1
DH040AC	AF20-063 x 1
DH040AO	10IF20-063 x 1
DH085AA	6IF20-102 x 1
DH085AC	AF20-102 x 1

### Flair

Part Number	Parker Part Number
-------------	--------------------

DH085AO	10IF20-102 x 1
DH195AA	6IF25-134 x 1
DH195AC	AF25-134 x 1
DH195AO	10IF25-134 x 1
DH295AA	6IF25-254 x 1
DH295AC	AF25-254 x 1
DH295AO	10IF25-254 x 1
DH400AA	6CF35-165 x 1
DH400AC	AF35-165 x 1
DH400AO	10CF35-165 x 1
DH500AA	6CF43-252 x 1
DH500AC	AF43-252 x 1
DH500AO	10CF43-252 x 1
HK71311C	6CH25-260 x 1
HK7319P	10CH25-260 x 1
UFAK0205	AJN08-024 x 1
UFAK0305	AJN08-030 x 1
UFAK0310	AJN10-030 x 1
UFAK0410	AJN10-040 x 1
UFAK0420	AJN13-040 x 1
UFAK0520	AJN13-050 x 1
UFAK0525	AJN15-050 x 1
UFAK0725	AJN15-070 x 1
UFAK0730	AJN25-070 x 1
UFAK1030	AJN25-100 x 1
UFAK1530	AGN25-150 x 1
UFAK2030	AGN25-200 x 1
UFAK3030	AGN25-300 x 1
UFAK3050	AGN43-300 x 1
UFFF0205	10HJN08-024 x 1
UFFF0305	10HJN08-030 x 1
UFFF0310	10CJN10-030 x 1
UFFF0410	10CJN10-040 x 1
UFFF0420	10CJN13-040 x 1
UFFF0520	10CJN13-050 x 1
UFFF0525	10IJN15-050 x 1
UFFF0725	10IJN15-070 x 1
UFFF0730	10IJN25-070 x 1
UFFF1030	10IJN25-100 x 1
UFFF1530	10IGN25-150 x 1
UFFF2030	10IGN25-200 x 1
UFFF3030	10IGN25-300 x 1
UFFF3050	10QGN43-300 x 1
UFMF0205	6HJN08-024 x 1
UFMF0305	6HJN08-030 x 1
UFMF0310	6CJN10-030 x 1
UFMF0410	6CJN10-040 x 1
UFMF0420	6CJN13-040 x 1
UFMF0520	6CJN13-050 x 1
UFMF0525	6IJN15-050 x 1
UFMF0725	6IJN15-070 x 1
UFMF0730	6IJN25-070 x 1
UFMF1030	6IJN25-100 x 1
UFMF1530	6IGN25-150 x 1
UFMF2030	6IGN25-200 x 1
UFMF3030	6IGN25-300 x 1
UFMF3050	6QGN43-300 x 1
UFPE0205	12GJN08-024 x 1
UFPE0305	12GJN08-030 x 1
UFPE0310	3PJN10-030 x 1
UFPE0410	3PJN10-040 x 1
UFPE0420	3PJN13-040 x 1
UFPE0520	3PJN13-050 x 1

### Flair

Part Number	Parker Part Number
-------------	--------------------

UFPE0525	3PJN15-050 x 1
UFPE0725	3PJN15-070 x 1
UFPE0730	3PJN25-070 x 1
UFPE1030	3PJN25-100 x 1
UFPE1530	3PGN25-150 x 1
UFPE2030	3PGN25-200 x 1
UFPE3030	3PGN25-300 x 1
UFPE3050	3PGN43-300 x 1
UFSMF0205	4HJN08-024 x 1
UFSMF0305	4HJN08-030 x 1
UFSMF0310	4CJN10-030 x 1
UFSMF0410	4CJN10-040 x 1
UFSMF0420	4CJN13-040 x 1
UFSMF0520	4CJN13-050 x 1
UFSMF0525	4IJN15-050 x 1
UFSMF0725	4IJN15-070 x 1
UFSMF0730	4IJN25-070 x 1
UFSMF1030	4IJN25-100 x 1
UFSMF1530	4IGN25-150 x 1
UFSMF2030	4IGN25-200 x 1
UFSMF3030	4IGN25-300 x 1
UFSMF3050	4QGN43-300 x 1
VCE15	6CC15-150 x 2
VCE22	6ICC25-220 x 1
VCE8100	6CC15-080 x 2
VCE860	6CC15-060 x 2
VCXE15	2CC15-150 x 2
VCXE22	2ICC25-220 x 1
VCXE8100	2CC15-080 x 2
Z2010Y	8CZ20-046 x 1
Z2010Z	10CZ20-046 x 1
Z2020A	AZ20-086 x 1
Z2020V	3PZ20-086 x 1
Z2020X	6CZ20-086 x 1
Z2020Y	8CZ20-086 x 1
Z2020Z	10CZ20-086 x 1
Z2030A	AZ20-126 x 1
Z2030V	3PZ20-126 x 1
Z2030X	6CZ20-126 x 1
Z2030Y	8CZ20-126 x 1
Z2030Z	10CZ20-126 x 1
Z2050A	AZ20-200 x 1
Z2050V	3PZ20-200 x 1
Z2050X	6CZ20-200 x 1
Z2050Y	8CZ20-200 x 1
Z2050Z	10CZ20-200 x 1
Z3050A	AZ27-200 x 1

# Par-Fit

## Parker Quality Elements for other Manufacturers' Housings

### Hankison

Part Number	Parker Part Number	Kit Required
-------------	--------------------	--------------

#### Oil Removal (Air Line Filter)

0731-3	10CM10-025 x 8	KX-21
0731-4	10CM10-050 x 4	KX-22
0731-5	10CM15-060 x 4	KX-23
0731-6	10CM15-095 x 2	KX-24
0731-7	10CM15-185 x 2	KX-25
0731-8	10CU25-187 x 1	KX-2
0731-9*	10CH25-260 x 1	
E7-12	10CH10-020 x 1	
E7-16	10CH10-036 x 1	
E7-20	10CH10-060 x 1	
E7-24	10CH16-066 x 1	
E7-28	10CH16-108 x 1	
E7-32	10CH19-131 x 1	
E7-36	10CH19-176 x 1	
E7-40	10CH25-204 x 1	
E7-44	10CH25-265 x 1	
E7-48	10CH25-323 x 1	
E7-PV	10CH25-260 x 1	

#### Ultra High Efficiency

#### Oil Removal Filters

E3-12	2CH10-020 x 1	
E3-16	2CH10-036 x 1	
E3-20	2CH10-060 x 1	
E3-24	2CH16-066 x 1	
E3-28	2CH16-108 x 1	
E3-32	2CH19-131 x 1	
E3-36	2CH19-176 x 1	
E3-40	2CH25-204 x 1	
E3-44	2CH25-265 x 1	
E3-48	2CH25-323 x 1	
E3-PV	2CH25-260 x 1	

#### Aeroliscer (High Efficiency Oil Removal Filters)

0713-2	6CM10-025 x 8	KX-21
0713-3	6CM10-050 x 4	KX-22
0713-4	6CM15-060 x 4	KX-23
0713-5	6CM15-095 x 2	KX-24
0713-6	6CM15-185 x 2	KX-25
0713-7	6CU25-187 x 1	KX-2
0713-8	6CU25-187 x 1	KX-2
0713-9	6CH25-260 x 1	
0713-11*	6CH25-260 x 1	
0713-12*	6CU25-187 x 1	KX-3
E5-12	6CH10-020 x 1	
E5-16	6CH10-036 x 1	
E5-20	6CH10-060 x 1	
E5-24	6CH16-066 x 1	
E5-28	6CH16-108 x 1	
E5-32	6CH19-131 x 1	
E5-36	6CH19-176 x 1	
E5-40	6CH25-204 x 1	
E5-44	6CH19-265 x 1	
E5-48	6CH25-323 x 1	
E5-PV	6CH25-260 x 1	

### Hankison

Part Number	Parker Part Number	Kit Required
-------------	--------------------	--------------

#### Hypersorb (Oil Vapour Removal Filter)

0715-2	AM10-025 x 8	KX-21
0715-3	AM10-050 x 4	KX-22
0715-4	AM15-060 x 4	KX-23
0715-5	AM15-095 x 2	KX-24
0715-6	AM15-185 x 2	KX-25
0715-7	AU25-187 x 1	KX-2
0715-8	AU25-187 x 1	KX-2
0715-9	AH25-260 x 1	
0715-11*	AH25-260 x 1	
E1-12	AH10-020 x 1	
E1-16	AH10-036 x 1	
E1-20	AH10-060 x 1	
E1-24	AHC16-066 x 1	
E1-28	AHC16-108 x 1	
E1-32	AHC19-131 x 1	
E1-36	AHC19-176 x 1	
E1-40	AHC25-204 x 1	
E1-44	AHC25-265 x 1	
E1-48	ACH25-323 x 1	
E1-PV	AH25-260 x 1	

#### Accumax (High Temperature Afterfilter)

0740-4	10DH25-260 x 1	
--------	----------------	--

#### Centriflex (Separator/Filter)

E9-12	100WS10-020 x 1	
E9-16	100WS10-036 x 1	
E9-20	100WS10-060 x 1	
E9-24	100WS10-066 x 1	
E9-28	100WS16-108 x 1	
E9-32	100WS19-131 x 1	
E9-36	100WS19-176 x 1	
E9-40	100WS25-204 x 1	
E9-44	100WS25-265 x 1	
E9-48	100WS25-323 x 1	
E9-PV	100WS25-260 x 1	

\*indicated number of elements required

Parker Quality Filter Elements are also available to fit in other manufacturers' housings. Please call for details.

Flair is a registered trademark of Flair Corporation;  
Hankison is a registered trademark of Flair Corporation;  
Headline is a registered trademark of Headline Filters Limited.



## Flowmeters

From an extensive range of inline flowmeters and monitors come a selection of products developed and calibrated specifically for compressed air applications.

Flowline flowswitches and flowmeters, calibrated for direct reading of compressed air at 7 barg, work in any plane for flow ranges from 2 - 2,200 SCFM 3.5 - 3,738 m<sup>3</sup>/h. Manufactured in brass, stainless steel or aluminium, they can be specified in any of 5 sizes.

To register your interest in Parker products please visit [www.parker.com/balstonuk](http://www.parker.com/balstonuk)



### 2000-series clamp kit

C02-2091; 2002, 2003, 2004, 2104  
C02-2121; 2206, 2208,  
C02-2122, 2312

Connects two or more 2000-series filter housings for multi-stage filtration



### KV-2A, KV-5A, KV-6A Element Frame Kits

(Internally mounted in all ASME housings)  
KV-2A XX51-280 elements  
KV-5A XX85-250 elements  
KV-6A XX85-360 elements



### MS-50 Metal Sump Drain (External)

Temp: 79°C  
Pressure: 17 barg  
1/8" NPT Drain Connection  
1/2" NPT Inlet Connection



### ADT-50 Float Actuated Drain Trap

Temp: 232°C  
Pressure: 10 barg  
1/2" NPT Inlet Connection  
1/4" NPT Drain Connection  
Larger H-series or coded housings



### KBDPI-25 Differential Pressure Gauge

Temp: 88°C  
Pressure: 17 barg  
(Kit includes 1/8" and 1/4" NPT brass fittings, flexible nylon tubing and mounting bracket) For wall mount or coded housings



### KBDPG-15 Differential Pressure Gauge Kit

Temp: 93°C  
Pressure: 17 barg  
(Kit includes 1/8" and 1/4" NPT brass fittings, flexible nylon tubing and mounting bracket)  
Wall mount or coded housings

# Global Company

## Local Support

---

Parker is the leader in motion and control, partnering with its customers to increase their productivity and profitability.

With an annual turnover of over \$10 billion and 59,000 employees Parker measures its success by what it does for you. Guided by a relentless drive to improve your products and processes, we bring our engineering know-how to your application, wherever it may be.

From 60 sales offices in 44 countries around the world Parker services 8,500 distributors and 1,500,000 customers.



## Quality Manufacturing

With over 270 manufacturing plants, Parker's manufacturing experience spans more than half a century. Our global reputation as a reliable supplier of superior products results from a focused and integrated development and manufacturing system. This begins with the customer – identifying needs, exploring opportunities and meeting the challenge of change.

Quality permeates through the entire corporation so that every employee thinks about what is expected by our customers.

Parker makes the technology investments needed to ensure the highest quality products. Each of our divisions has ISO certification.

## Premier Customer Service

We are doing more for our customers than ever before. Globally, we have localized service to provide fast, hassle free response and on-site support. We're staying close to our customers and integrating systems to help them become more profitable. We are committed to delivering our highly engineered products on-time, on-promise. Parker's global customer service centres respond to more than 20,000 inquiries each month, helping callers quickly find the products and solutions they need.



## Innovation

We are leveraging our engineering expertise and breadth of product to create breakthrough innovations, processes and services that anticipate, rather than react, to customer needs. We're adapting our technology platforms across the markets we serve, combining what we know in new ways to better serve our customers. And we're creating smarter products by blending our expertise in electronic controls with our mechanical devices.



**Parker Hannifin**

Hermitage Court, Hermitage Lane, Maidstone, Kent ME16 9NT, England

Phone: +44 (0)1622 723 300 Fax: +44 (0)1622 728 703 E-mail: [pagsservicesupport@parker.com](mailto:pagsservicesupport@parker.com) Web site: [www.parker.com/pag](http://www.parker.com/pag)



#### **Parker Filtration & Separation**

Process Air and Gas Division  
Hermitage Court  
Hermitage Lane  
Maidstone  
Kent  
ME16 9NT  
United Kingdom  
Tel: +44 (0)1622 723 300  
Fax: +44 (0)1622 728 703  
E-mail: [pagservicesupport@parker.com](mailto:pagservicesupport@parker.com)

#### **Parker Hannifin Bv**

Filtration and Separation Division  
P.O. Box 258  
4870 AG Etten-Leur  
The Netherlands  
Tel: +31 (0)76 508 5300  
Fax: +31 (0)76 508 5333  
Email: [pfsinfo@parker.com](mailto:pfsinfo@parker.com)

#### **Parker Hannifin Corporation**

Filtration and Separation Division  
242 Neck Road  
P.O. Box 8223  
Haverhill, MA 01835-0723  
USA  
Tel: +1 800-343-4048  
Fax: +1 978-858-0625

#### **Parker European Sales Offices**

Austria +43 2622 235010  
Belgium +32 67 280900  
Czech Republic +420 284 083 11  
Denmark +45 43 560400  
Finland +358 20 753 2500  
France +33 (0)450 258025  
Germany +49 (0)2131 40160  
Hungary +36 (0)12204155  
Italy +39 02 452424  
Netherlands +31 541 585000  
Norway +47 64911000  
Poland +48 (0)22 5732400  
Spain + 34 91 6757300  
Sweden + 46 8 59795000  
Switzerland +41 22 3077111



**For further information on other Parker products call the European Product Information Centre free of charge on 00800 27 27 5374 or email: [epic@parker.com](mailto:epic@parker.com)**

## **Catalogue S3.2.111a Rev 6**

S3.2.111a  
SCAR/006/04/07

Every effort has been made to ensure the accuracy of this document at the time of printing. In accordance with company's policy of continued product improvement Parker Hannifin reserves the right to make product changes without notice. No liability is accepted for any consequential losses, injury or damage resulting from the use of this document or from any omissions or errors herein. The data is given for guidance only. It does not constitute a specification or an offer for sale. The products are always subject to a programme of improvement and testing which may result in some changes in the characteristics quoted. As the products may be used by the client in circumstances beyond the knowledge and control of Parker Hannifin, we cannot give any warranty as to the relevance of these particulars to an application. It is the client's responsibility to carry out the necessary tests to determine the usefulness of the products and to ensure their safety of operation in a particular application.

